



### Główne materiały

Obudowa pompy, obudowa silnika, pokrywa silnika: mosiądz B 10  
Wirnik: stal nierdzewna AISI 316,  
Wał silnika: stal nierdzewna AISI 316 L,  
Elementy łączące: stal nierdzewna AISI 316,  
uszczelnienie wargowe z nitylu w silnikach do 2 kW,  
Uszczelnienie mechaniczne strony silnika: grafit/ceramika do 2 kW  
Uszczelnienie mechaniczne strony pompy: węgiel krzemu/węgiel krzemu/FPM

### Budowa

Pompy zatapialne, wersja z mosiądzu B 10  
B-GMV z wirnikiem o swobodnym przepływie (vortex)  
B-GMC z wirnikiem jednokanałowym  
B-GMN z wirnikiem kanałowym  
podwójne uszczelnienie mechaniczne w komorze olejowej  
króćce tłoczne DN 50, DN65, DN80.

### Zastosowania

do pompowania płynów agresywnych, szczególnie w zastosowaniach przemysłowych,  
maksymalna wielkość zanieczyszczeń: 40-50 mm.

### Warunki pracy pompy

Temperatura płynu do 40°C  
Maksymalna głębokość zanurzenia: 20 m (z odpowiednią długością kabla)  
Praca ciągła (z silnikiem całkowicie zanurzonym)

### Silnik

Silnik indukcyjny dwubiegunowy, 50 Hz, wersja trójfazowa: 400 V +/- 10%, do 3,1 kW, 400/690 V +/- 10%, ponad 3,1 kW  
Klasa izolacji H  
stopień ochrony IP 68  
dopuszczalna liczba uruchomień: 15/h w regularnych odstępach czasu,  
Kabel: H07RN8-F, długość 10 m  
Pozostałe modele: proszę kontaktować się z naszym biurem sprzedaży

### Coverage chart

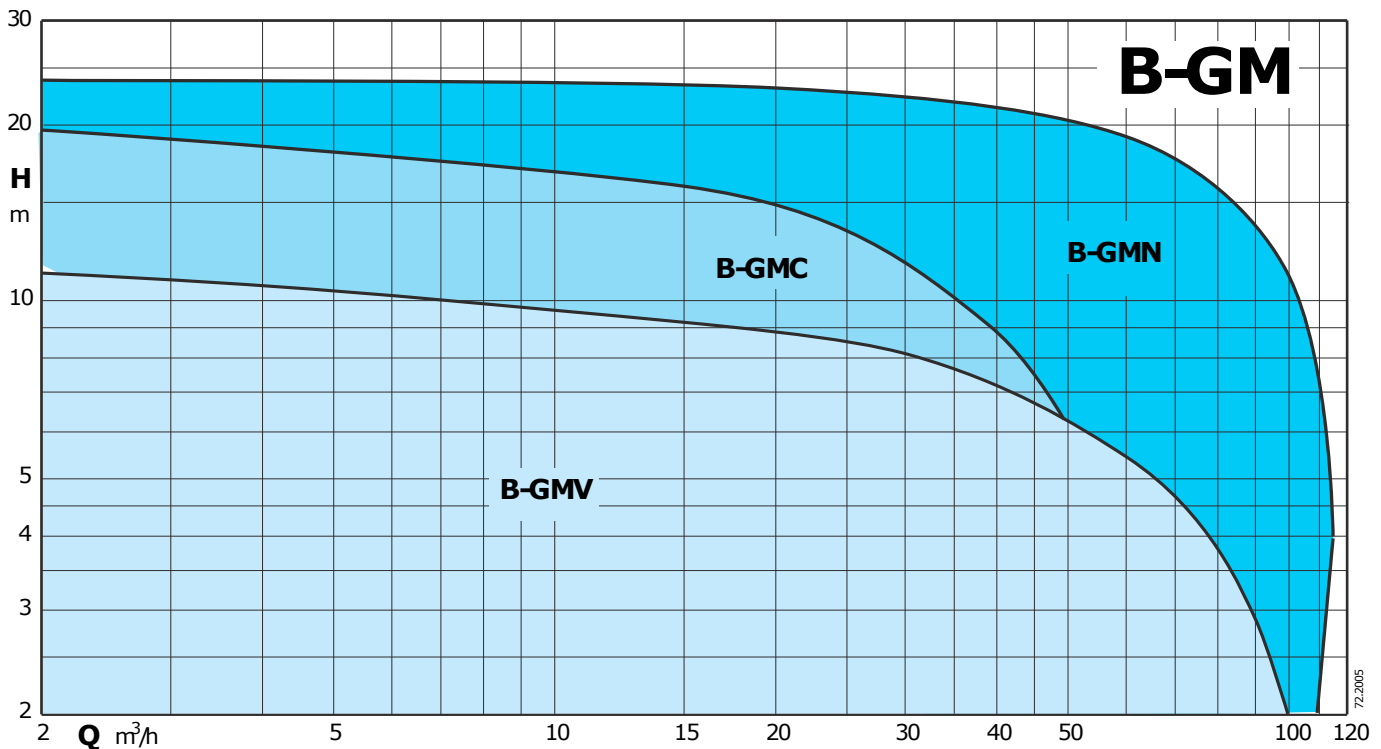



### Construction

Submersible pumps, **B 10 bronze marine** version.

**B-GMV** with free-flow (vortex) impeller

**B-GMC** with single-channel impeller

**B-GMN** with channels impeller

Twin mechanical seal with oil chamber (lip-seal motor side up to 2,4 kW 2 poles).

Delivery connection DN 50-65-80

### Applications

Suitable to pump industrial waste water in chemical, and process industries, agricultural and marine areas.

Solid passage from 30 to 50 mm

### Operating conditions

Liquid temperature up to 40 °C.

Maximum immersion depth: 20 m (with suitable cable length).

Continuous duty (with pump immersed at minimum level).

### Main materials

Pump casing, Motor casing, Motor cover: B 10 bronze marine

Impeller: stainless steel AISI 316

Motor shaft: stainless steel AISI 316L

Screws: stainless steel AISI 316

Mechanical seal motor side: graphite/ceramic/FPM (lip-seal made of nitrile up to 2,4 kW 2 poles).

Mechanical seal pump side: silicon carbide/silicon carbide/FPM

### Motor

2 or 4 poles induction, 50Hz

Three-phase version: 400V ± 10%, up to 3,2 kW

400/690V ± 10%, over 3,2 kW

Insulation class: H

Protection degree: IP 68

N° of starting x hour: max 15 with regular intervals

Cable: H07RN-F, length 10 m

Other models: contact our sale office

### Coverage chart

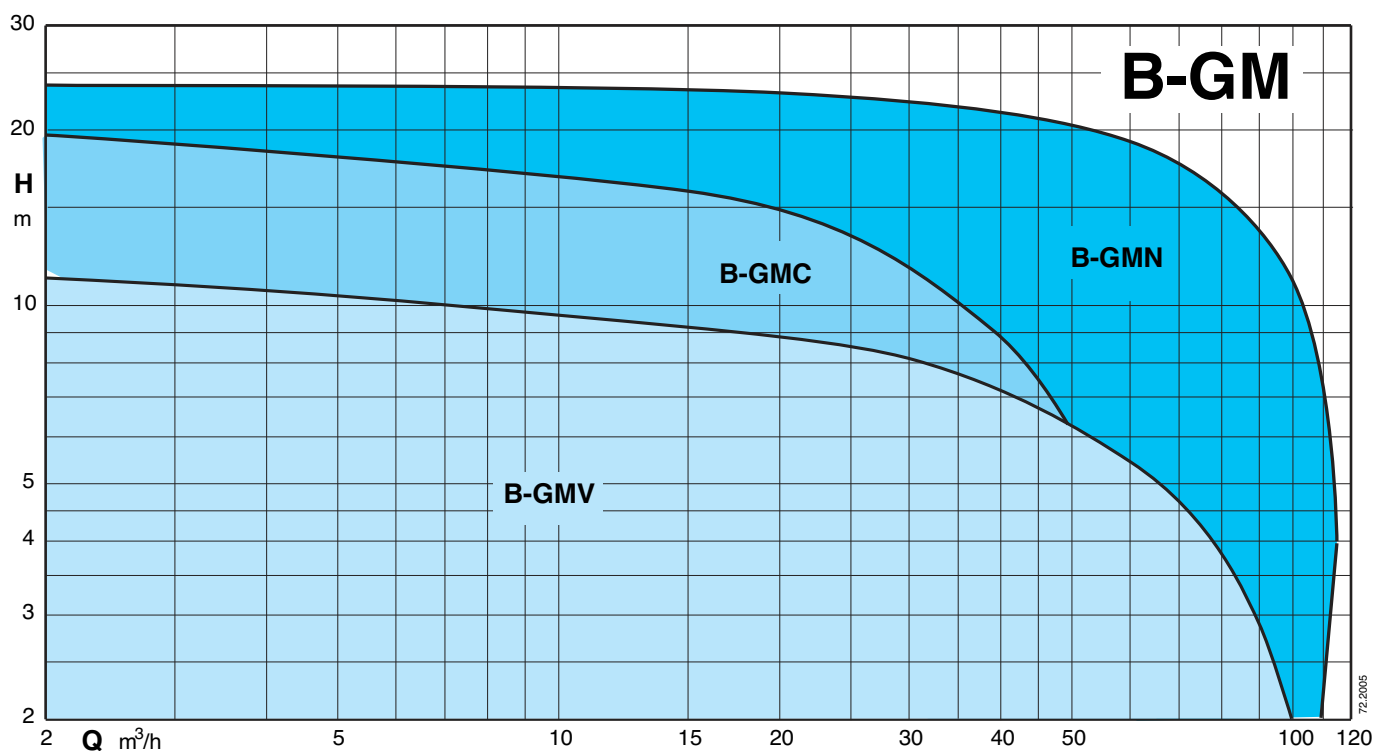

### Technical data

TYPE	P <sub>2</sub> kW	I <sub>N</sub> A	Power Supply	r.p.m.	Starting	DN mm	Free passage Ø mm	Thermal protector	Humidity probe	 ATEX Eex
B-GMV 50-50B	1,0	2,5	3~ 400V	2850	D.O.L.	50	50	NO	NO	✓
B-GMV 50-50A	1,4	3,5	3~ 400V	2850	D.O.L.	50	50	NO	NO	✓
B-GMV4 50-65C	1	3	3~ 400V	1450	D.O.L.	65	50	NO	NO	✓
B-GMV4 50-65B	1	3	3~ 400V	1450	D.O.L.	65	50	NO	NO	✓
B-GMV4 50-65A	1,4	3,5	3~ 400V	1450	D.O.L.	65	50	NO	NO	✓
B-GMV4 50-80B	2,3	5	3~ 400V	1450	D.O.L.	80	50	NO	NO	✓
B-GMV4 50-80A	2,8	6,5	3~ 400V	1450	D.O.L.	80	50	NO	NO	✓
B-GMC 40-65B	2,4	5	3~ 400V	2850	D.O.L.	65	40	NO	NO	✓
B-GMC 40-65A	2,9	6	3~ 400V	2850	D.O.L.	65	40	NO	NO	✓
B-GMN 30-65B	3,2	6,5	3~ 400V	2850	D.O.L.	65	30	NO	NO	✓
B-GMN 30-65A	3,2	6,5	3~ 400V	2850	D.O.L.	65	30	NO	NO	✓
B-GMN 30-80B	5,7	12,5	3~ 400/690V	2850	Y/Δ	80	30	●	●	✓
B-GMN 30-80A	5,7	12,5	3~ 400/690V	2850	Y/Δ	80	30	●	●	✓

P<sub>2</sub> Rated power output

I<sub>N</sub> Rated current

● Standard

✓ ATEX Eex Version on demand

## Characteristic curves

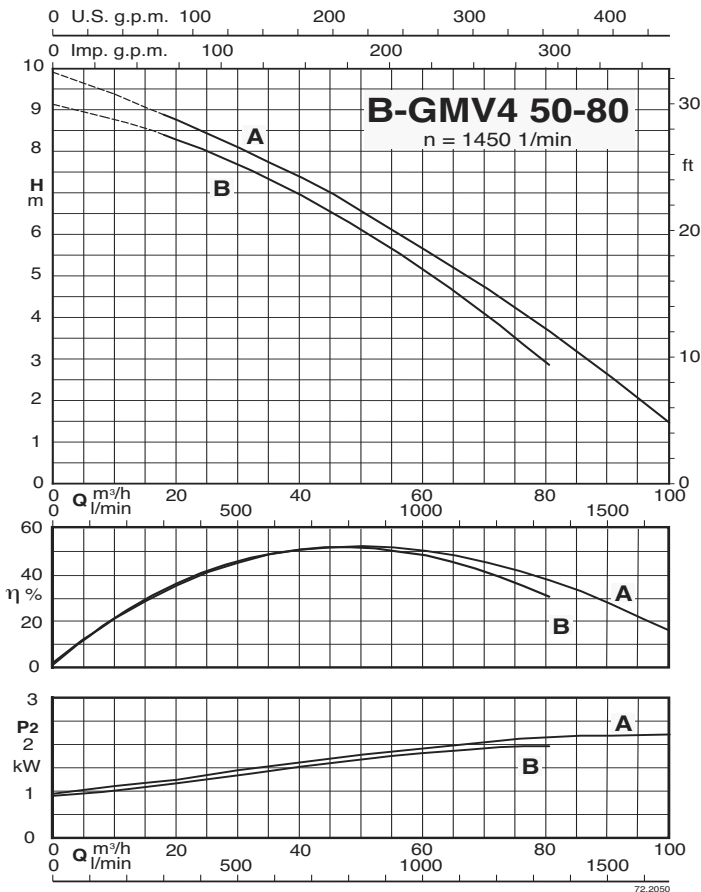
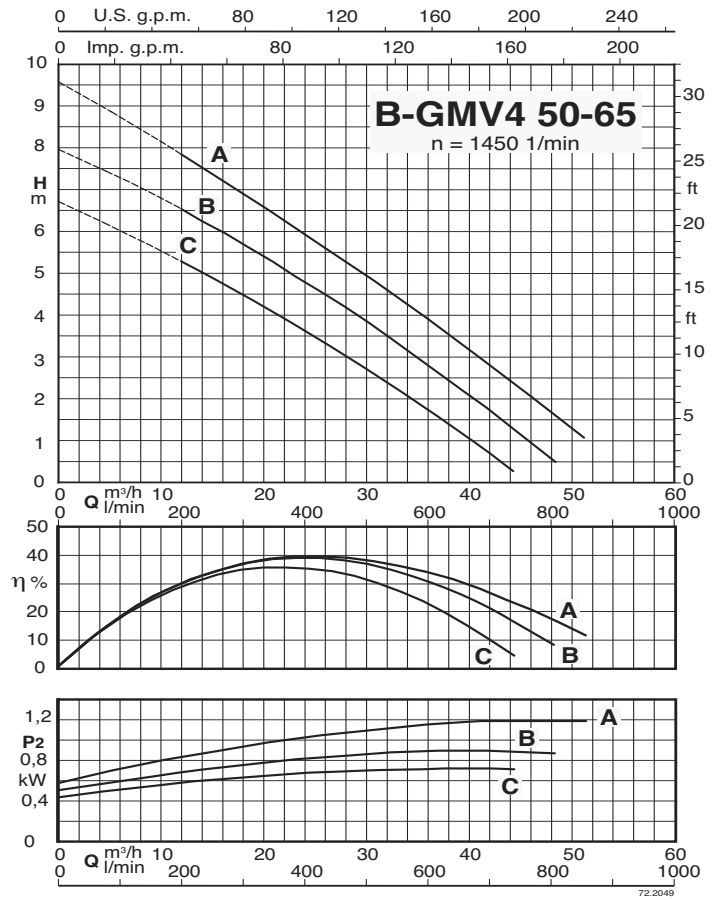
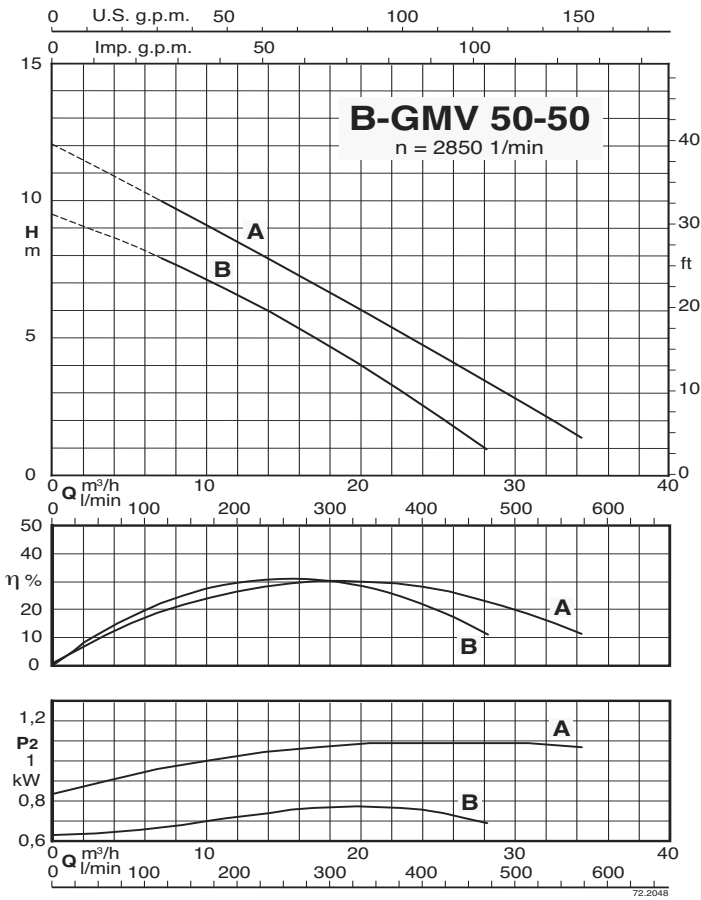

## Characteristic curves

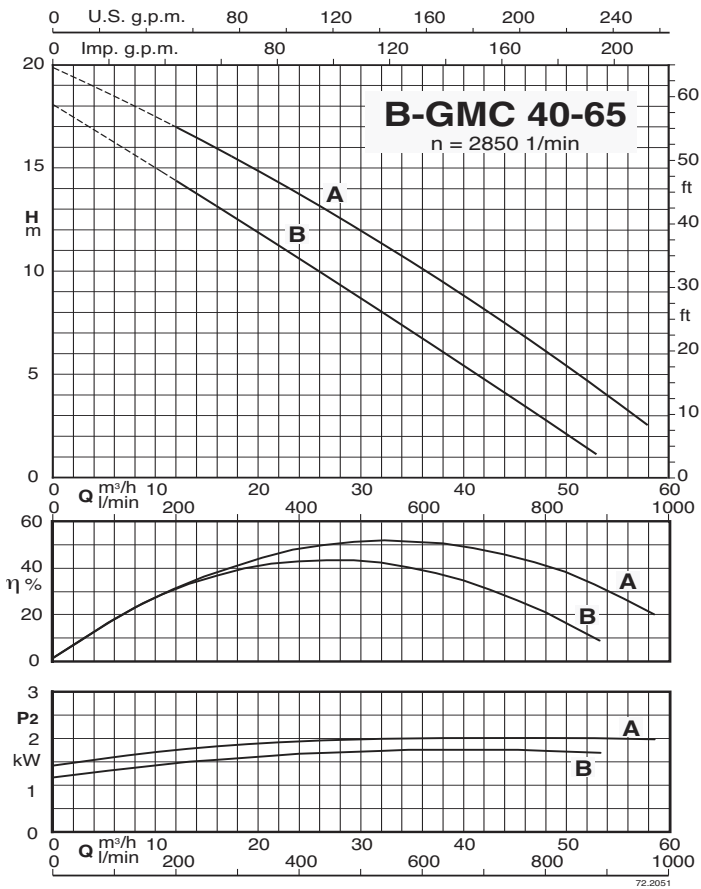

## Characteristic curves

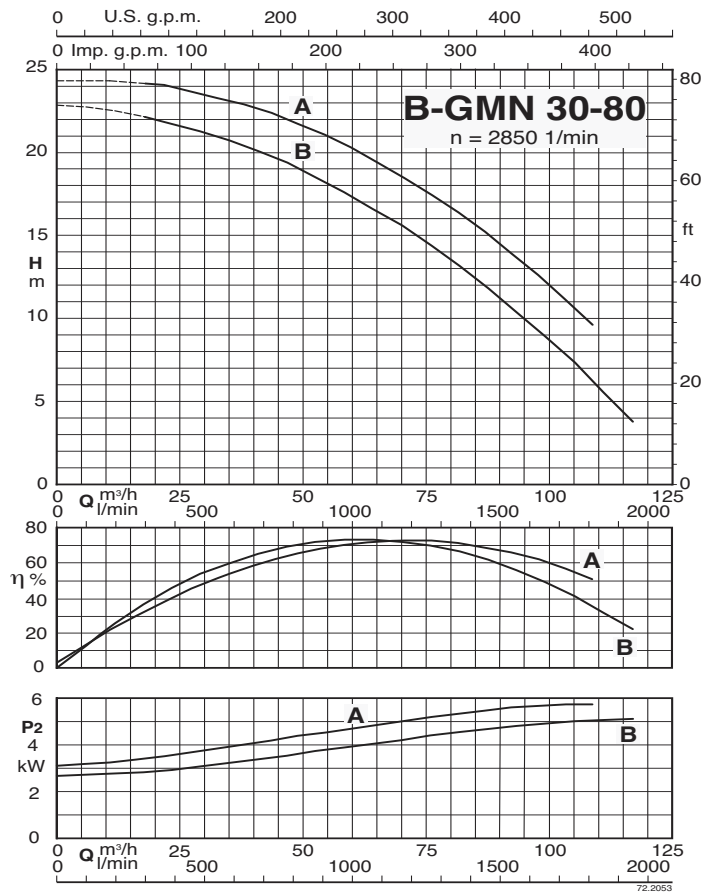
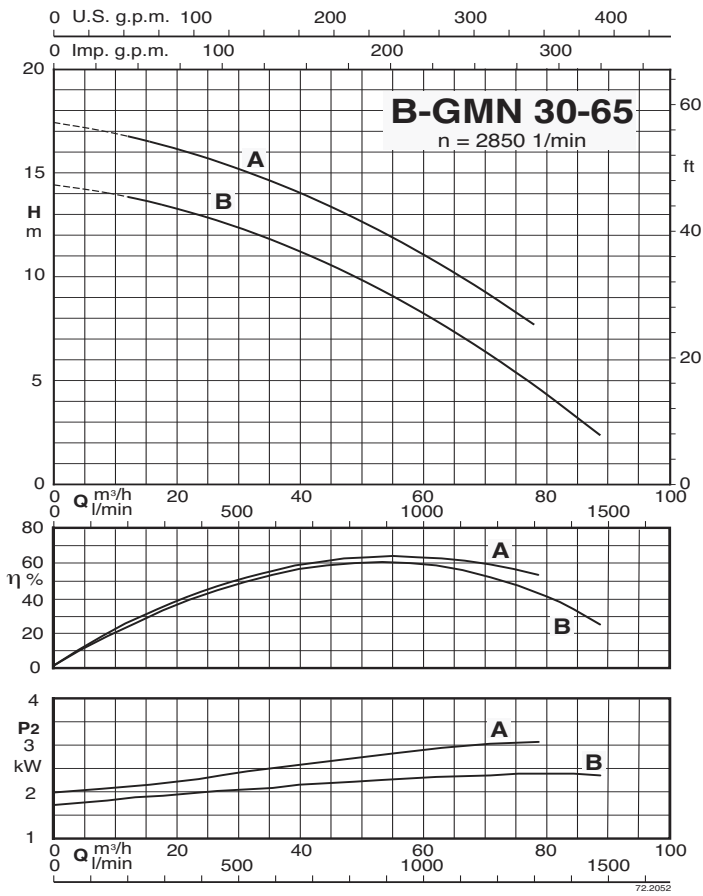

## Dimensions and weights

### B-GMV 50-50

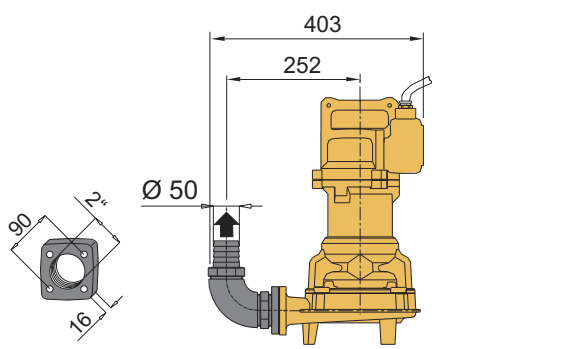
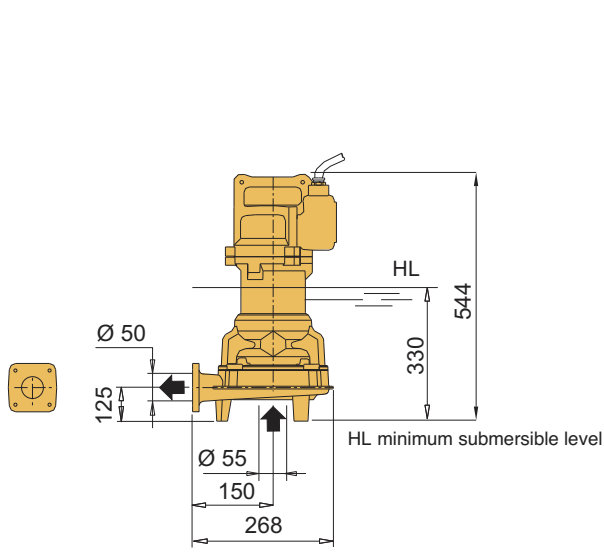

Version with threaded flange and 90° elbow

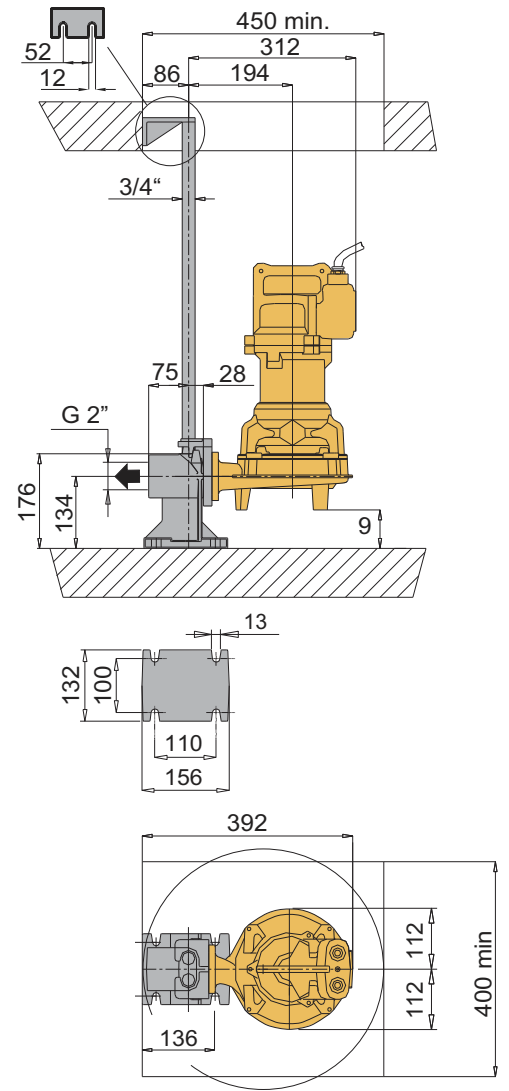

Version with duck foot coupling

TYPE	Weight kg
B-GMV 50-50B	48
B-GMV 50-50A	

## Dimensions and weights

**B-GMV4 50-65**  
**B-GMC 40-65**

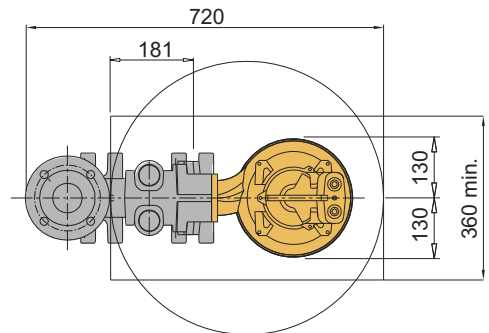
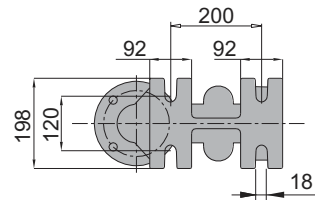
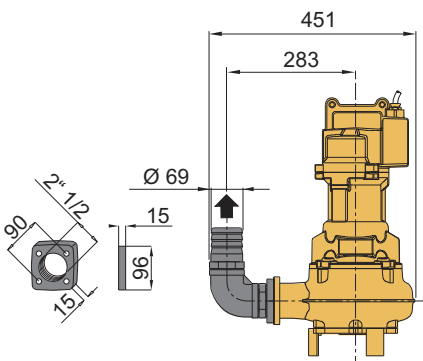
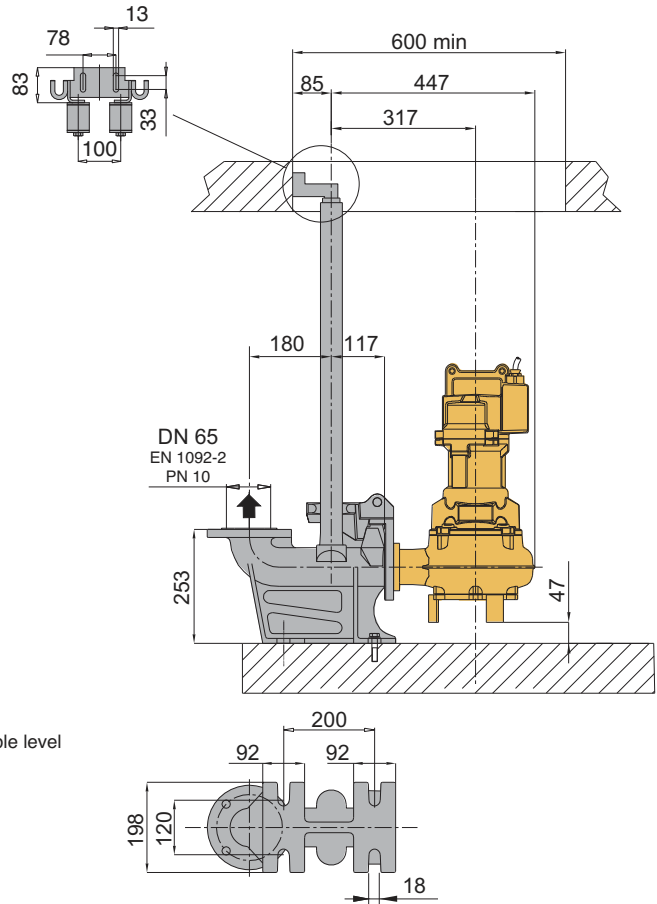
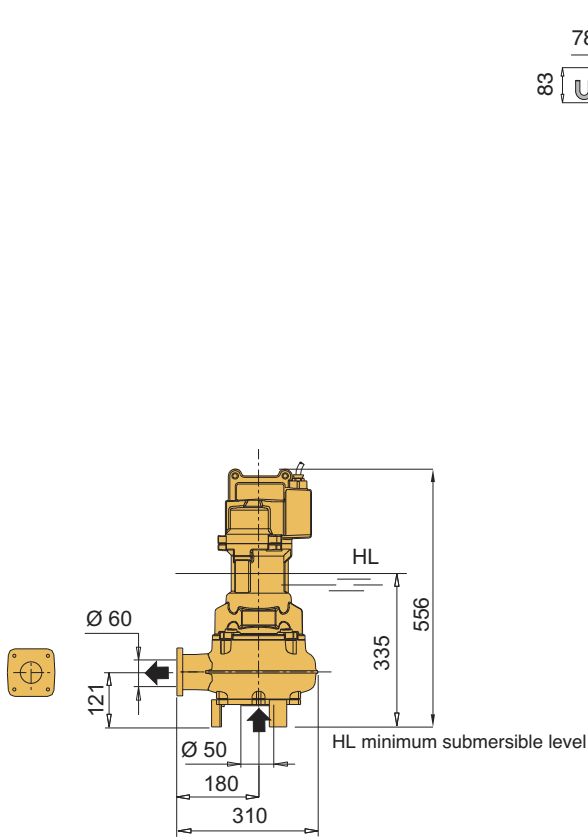

Version with threaded flange and 90° elbow

Version with duck foot coupling

TYPE	Weight kg
B-GMV4 50-65C	48
B-GMV4 50-65B	
B-GMV4 50-65A	
B-GMC 40-65B	50
B-GMC 40-65A	



## Dimensions and weights

### B-GMN 30-65

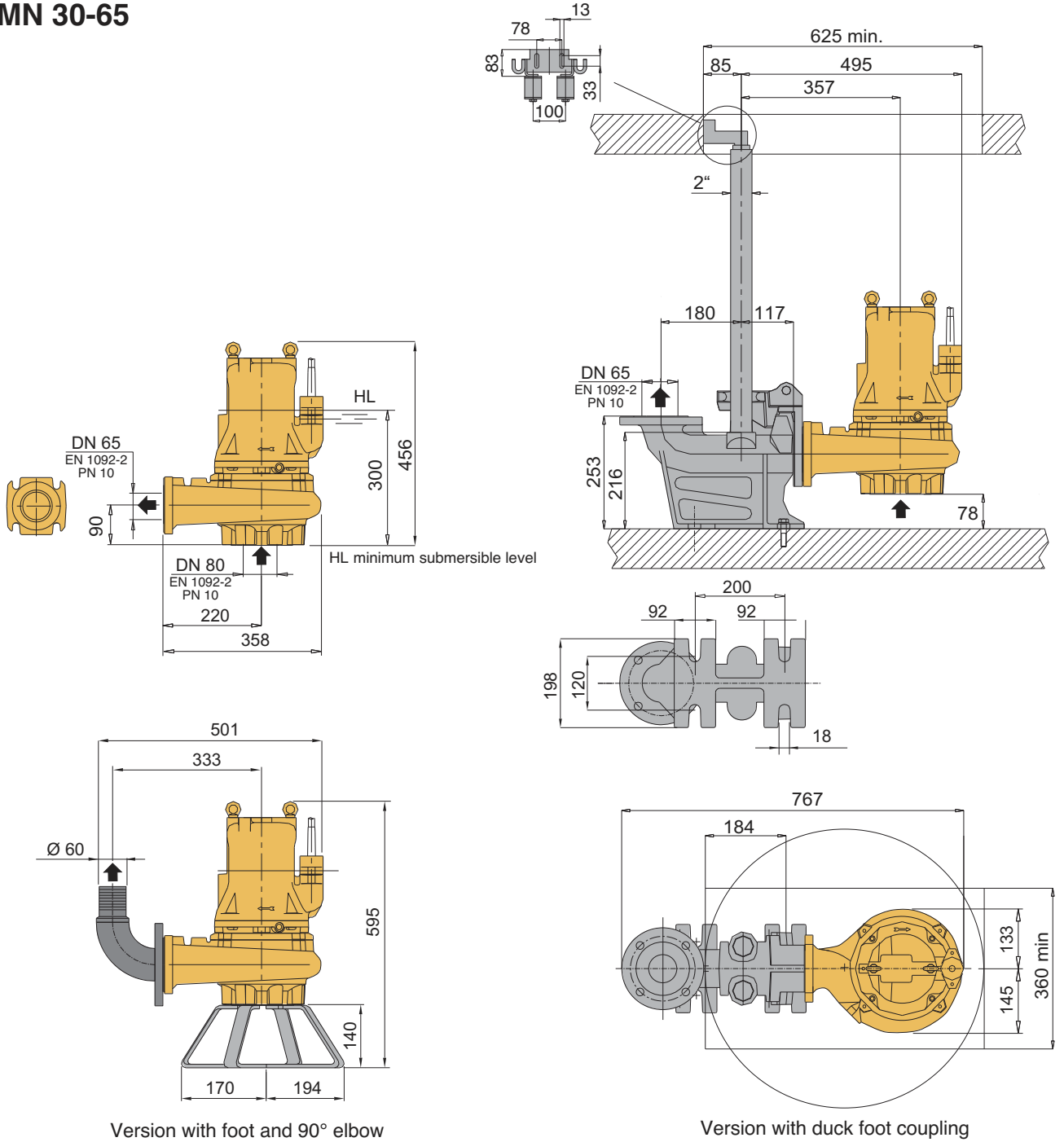

Version with foot and 90° elbow

Version with duck foot coupling

TYPE	Weight kg
B-GMN 30-65B	57
B-GMN 30-65A	57

### Dimensions and weights

**B-GMV4 50-80**  
**B-GMN 30-80**

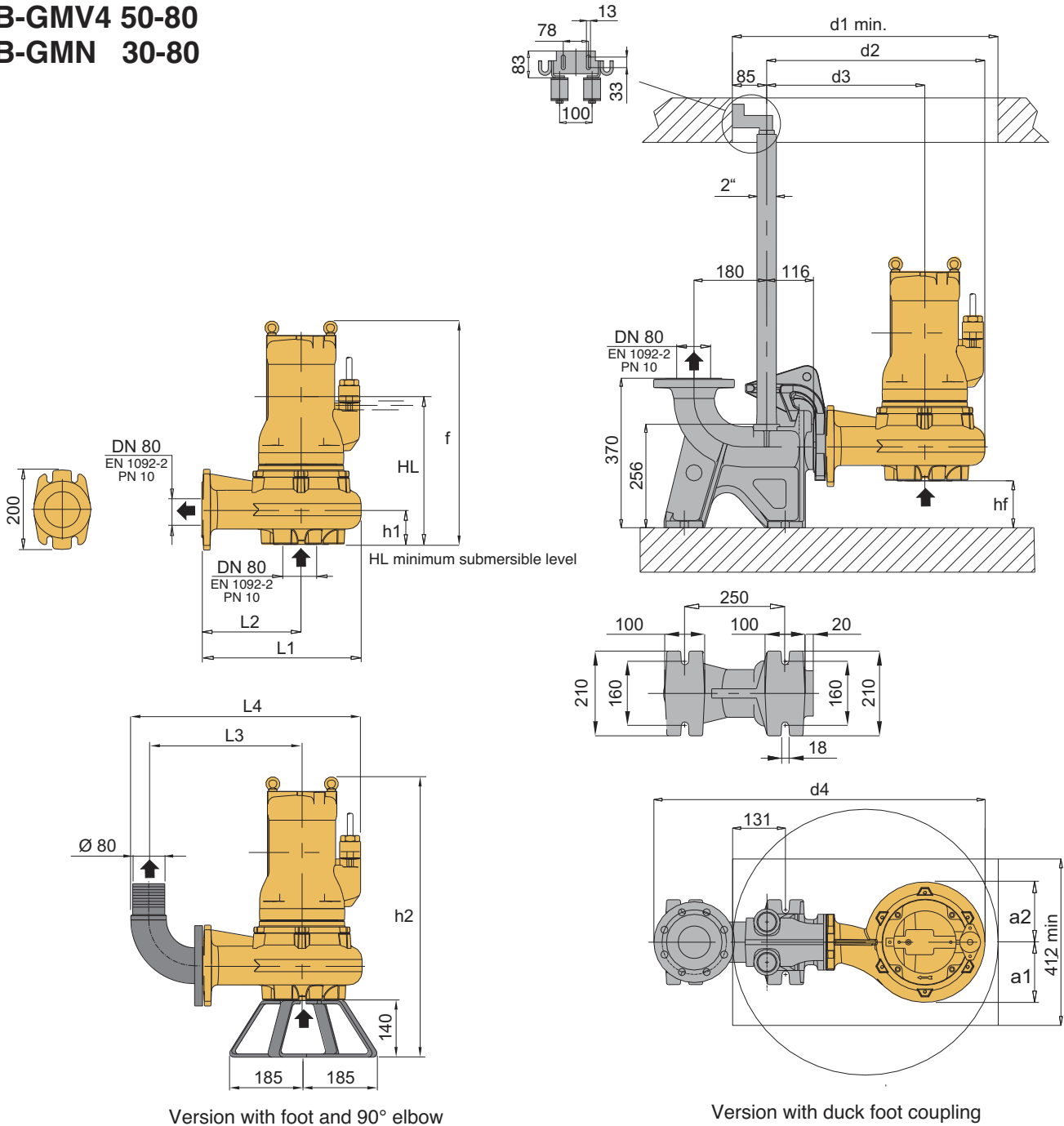

TYPE	EN 1092-2 PN 10		Dimensions mm														Weight kg	
	DN1	DN2	f	HL	hf	h1	h2	a1	a2	d1	d2	d3	d4	L1	L2	L3		L4
B-GMV4 50-80B	80	80	519	363	84	116	659	136	157	658	511	366	791	365	220	355	544	75
B-GMV4 50-80A																		
B-GMN 30-80B	80	80	515	330	110	90	655	133	145	700	511	366	791	365	220	355	544	84
B-GMN 30-80A																		