



Główne materiały

Korpus pompy, obudowa silnika, pokrywa silnika: żeliwo EN-GJL-250
 Wirnik: żeliwo EN-GJL-250+Ni
 Wał: stal nierdzewna AISI 420B
 Uszczelnienie mechaniczne od strony silnika: grafit/ceramika
 Uszczelnienie mechaniczne od strony pompy: węgiel krzemu/węgiel krzemu.

Budowa

Pompy zatapialne z wirnikiem o swobodnym przepływie. Podwójne uszczelnienie mechaniczne w komorze olejowej Średnica króćca tłocznego: DN 80-100.

Zastosowania

Są przeznaczone do pompowania ścieków i osadów, zawierających ciała stałe i włókniste, w instalacjach przemysłowych i domowych. Dopuszczalna wielkość ciał stałych w ściekach: do 90 mm.

Warunki pracy pompy

Temperatura płynu do 40°C
 Maksymalna głębokość zanurzenia: 20 m (z odpowiednią długością kabla)
 Praca ciągła (z silnikiem całkowicie zanurzonym)

Silnik

Silnik indukcyjny dwu- lub czterobiegunowy, 50 Hz wersja trójfazowa 400 V +/- 10%, do 3,1 kW 400/690 V +/- 10%, ponad 3,1 kW
 Klasa izolacji H
 Stopień ochrony IP 68
 Dopuszczalna liczba łączy/godzinę: 15, w regularnych odstępach czasu
 Przewód zasilający: H07RN8-F, długość 10 m
 Pozostałe wersje: w uzgodnieniu z lokalnym dystrybutorem.

Coverage chart

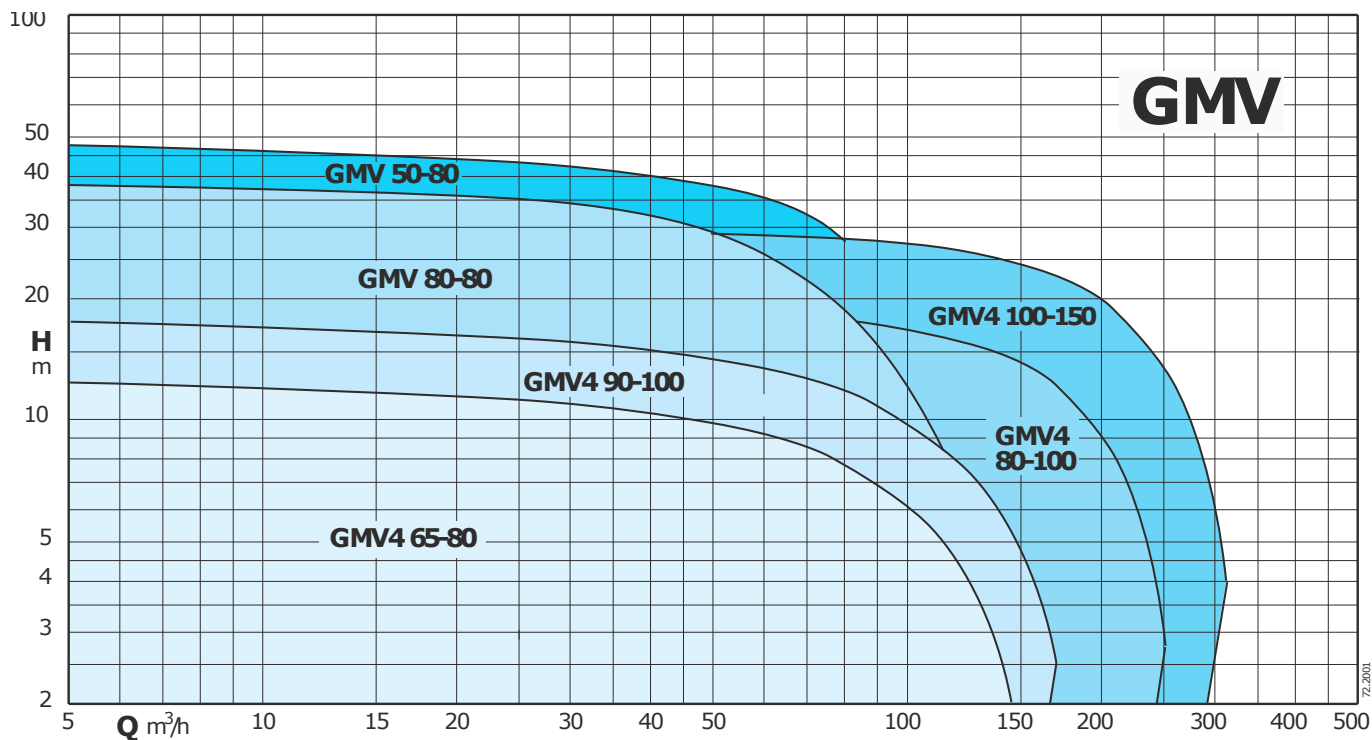

Technical data

TYPE	P ₂ kW	I _N A	Power Supply	r.p.m.	Starting	DN mm	Free passage Ø mm	Thermal protector	Humidity probe	ATEX Eex
GMV 50-80F	3,2	6,5	3~ 400V	2850	D.O.L.	80	50	NO	NO	✓
GMV 50-80E	3,2	6,5	3~ 400V	2850	D.O.L.	80	50	NO	NO	✓
GMV 50-80D	5	11	3~ 400/690V	2850	Y/Δ	80	50	●	●	✓
GMV 50-80C	5,7	12,5	3~ 400/690V	2850	Y/Δ	80	50	●	●	✓
GMV 50-80B	18,2	34	3~ 400/690V	2850	Y/Δ	80	50	●	●	✓
GMV 50-80A	18,2	34	3~ 400/690V	2850	Y/Δ	80	50	●	●	✓
GMV 70-80A	7,4	13,8	3~ 400/690V	2850	Y/Δ	80	70	●	●	✓
GMV 80-80B	15,9	30	3~ 400/690V	2850	Y/Δ	80	80	●	●	✓
GMV 80-80A	18,2	34	3~ 400/690V	2850	Y/Δ	80	80	●	●	✓
GMV 80-80S	24,8	44	3~ 400/690V	2850	Y/Δ	80	80	●	●	✓
GMV4 65-80D	2,8	6,5	3~ 400V	1450	D.O.L.	80	65	NO	NO	✓
GMV4 65-80C	2,8	6,5	3~ 400V	1450	D.O.L.	80	65	NO	NO	✓
GMV4 65-80B	3,8	8	3~ 400/690V	1450	Y/Δ	80	65	●	●	✓
GMV4 65-80A	4,6	9,5	3~ 400/690V	1450	Y/Δ	80	65	●	●	✓
GMV4 90-100B	5	11	3~ 400/690V	1450	Y/Δ	100	90	●	●	✓
GMV4 90-100A	7,1	13,5	3~ 400/690V	1450	Y/Δ	100	90	●	●	✓
GMV4 80-100C	10,1	22	3~ 400/690V	1450	Y/Δ	100	80	●	●	✓
GMV4 80-100B	14,1	30	3~ 400/690V	1450	Y/Δ	100	80	●	●	✓
GMV4 80-100A	14,1	30	3~ 400/690V	1450	Y/Δ	100	80	●	●	✓
GMV4 80-100S	25,4	48,5	3~ 400/690V	1450	Y/Δ	100	80	●	●	✓
GMV4 100-150E	25,4	48,5	3~ 400/690V	1450	Y/Δ	150	100	●	●	✓
GMV4 100-150B	25	48	3~ 400/690V	1450	Y/Δ	150	100	●	●	✓
GMV4 100-150A	35,7	65,5	3~ 400/690V	1450	Y/Δ	150	100	●	●	✓

 P₂ Rated power output

 I_N Rated current

● Standard

✓ ATEX Eex Version on demand

Characteristic curves

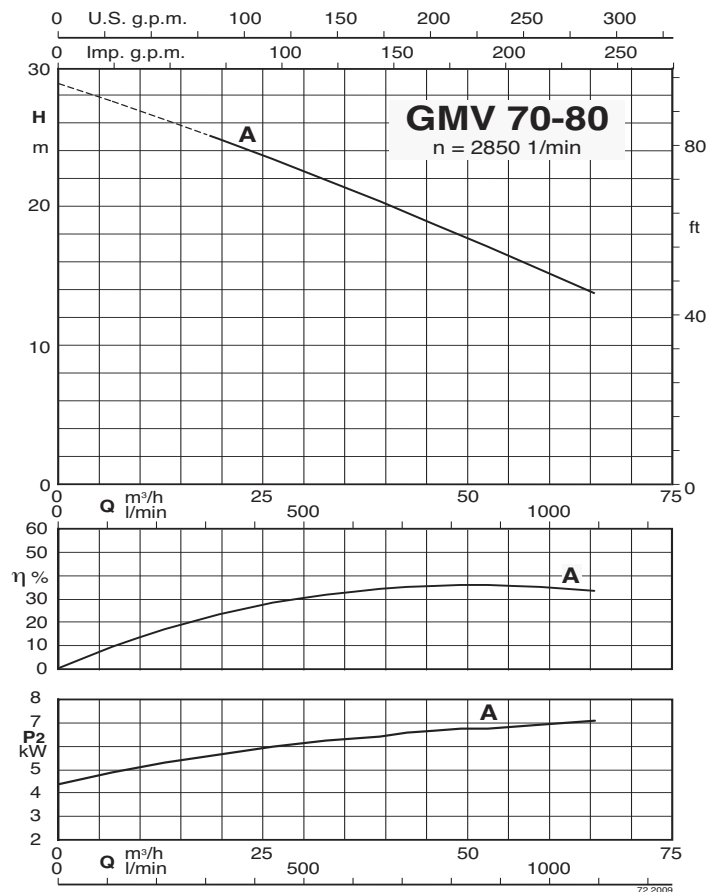
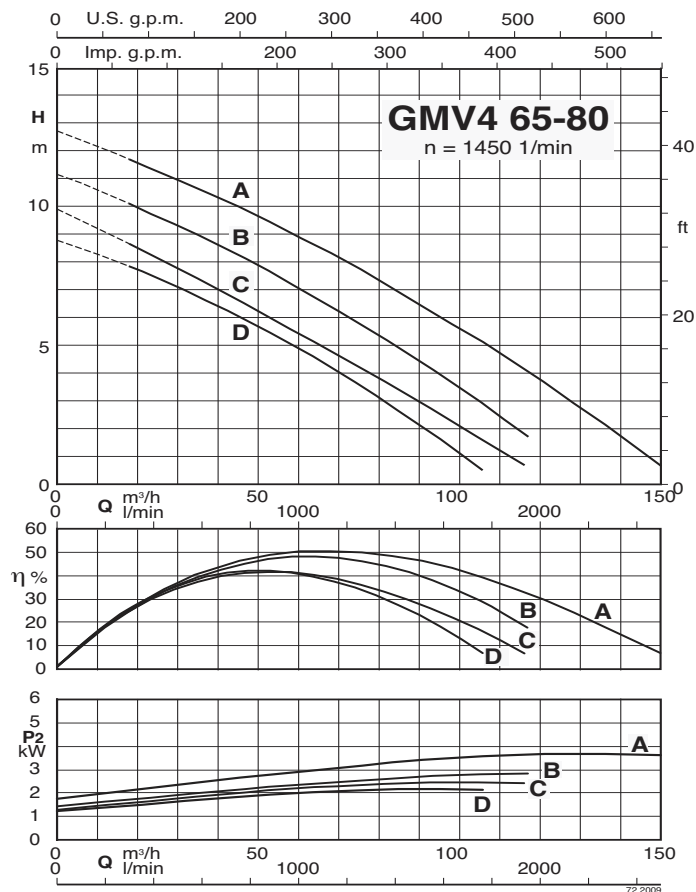
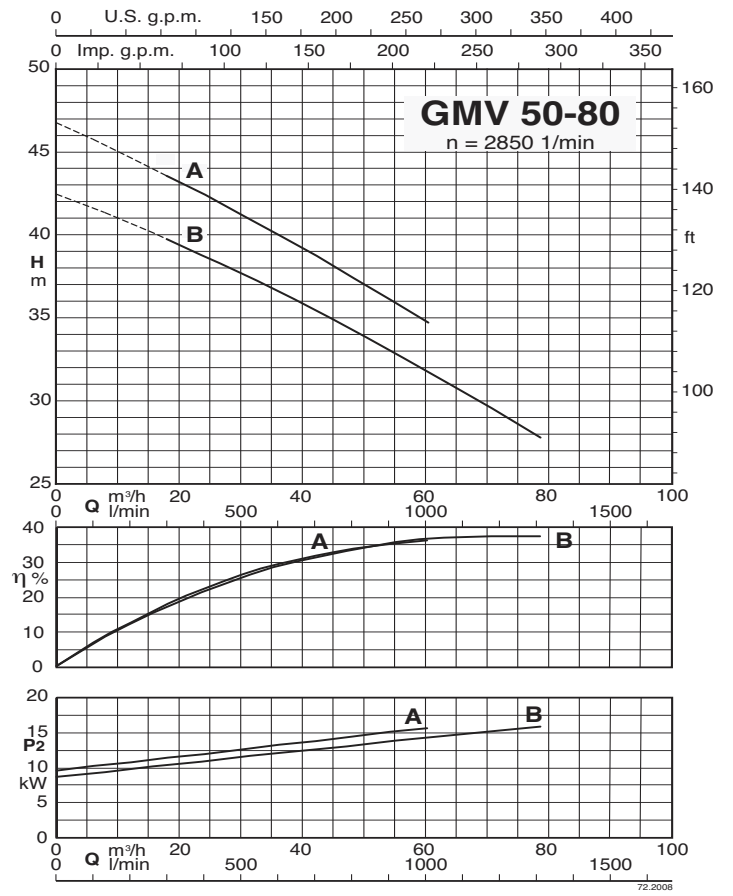
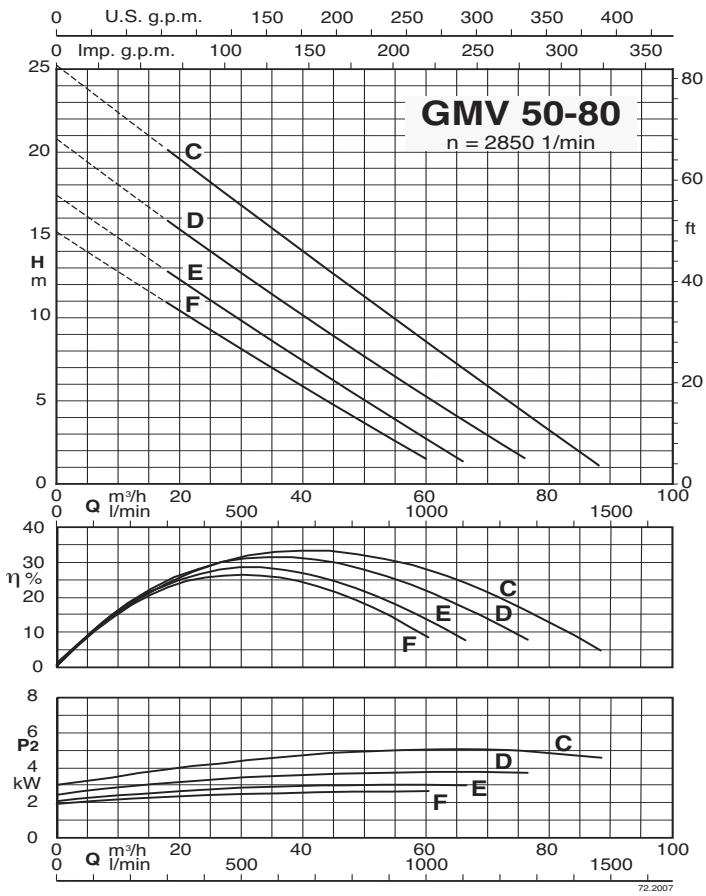

Characteristic curves

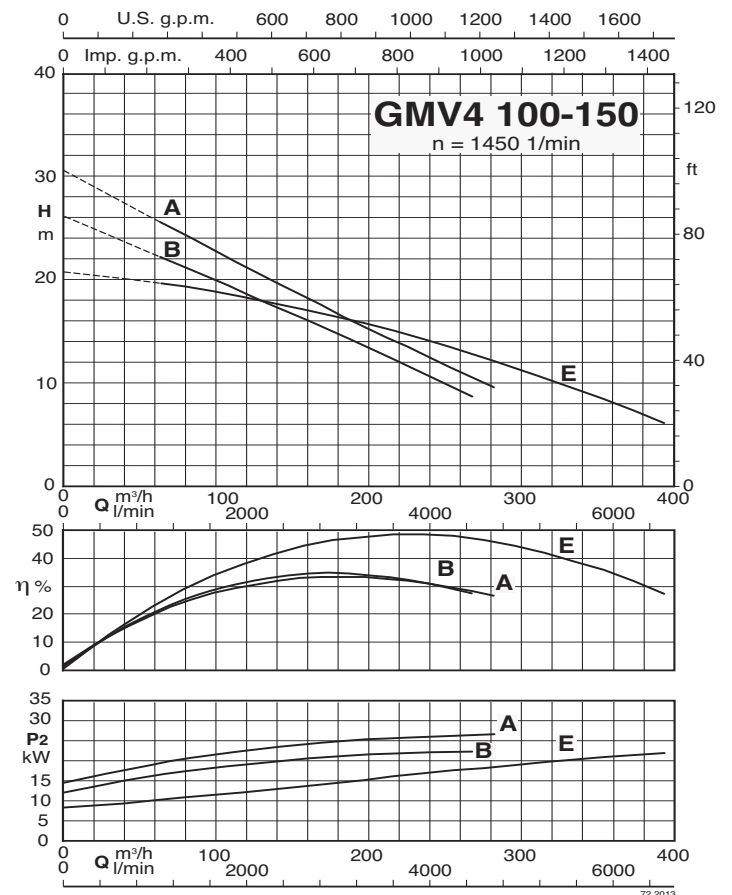
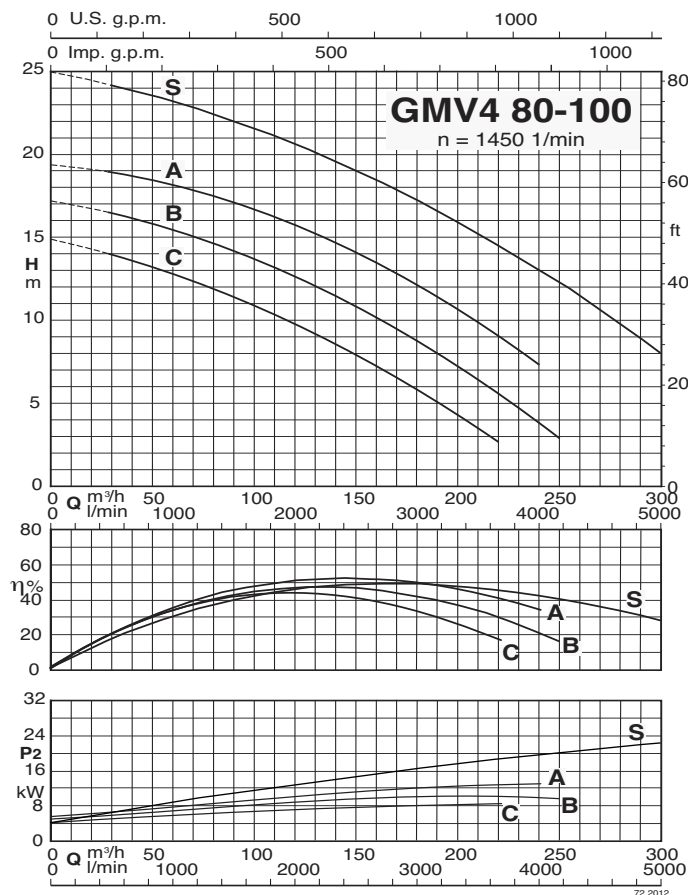
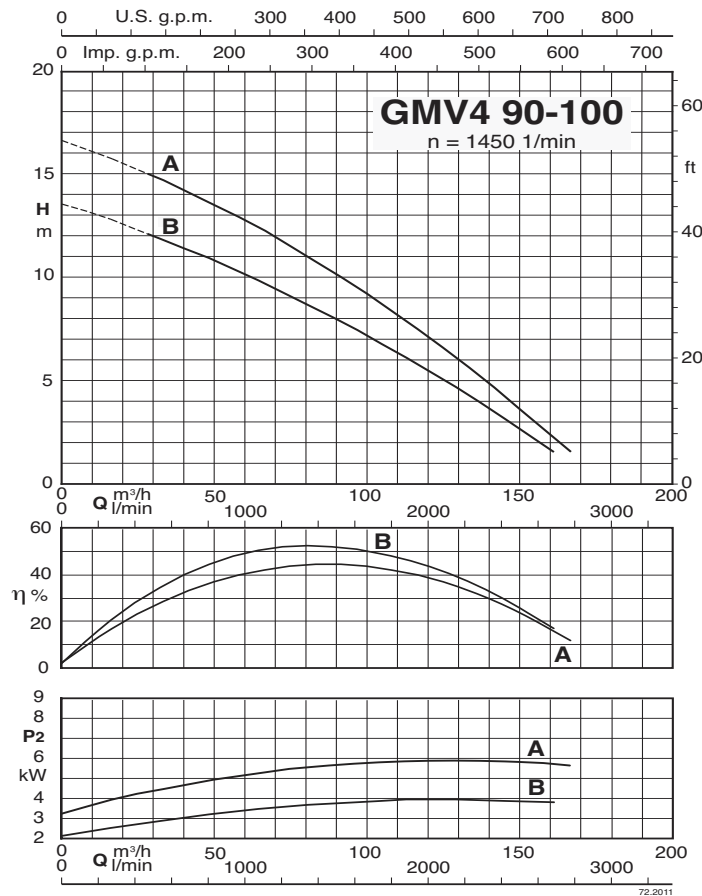
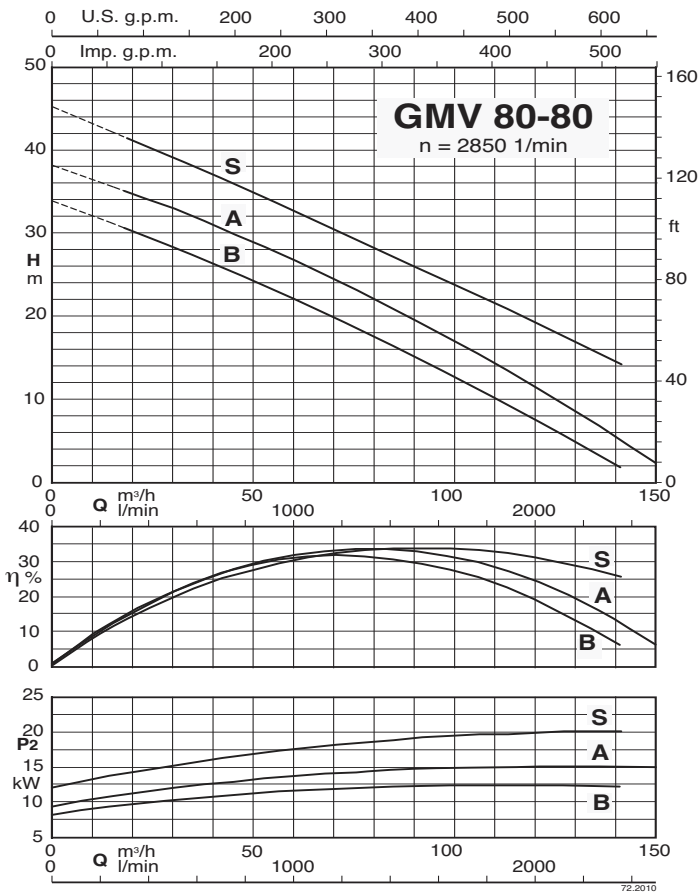

Dimensions and weights

GMV 50-80
GMV 80-80
GMV4 65-80

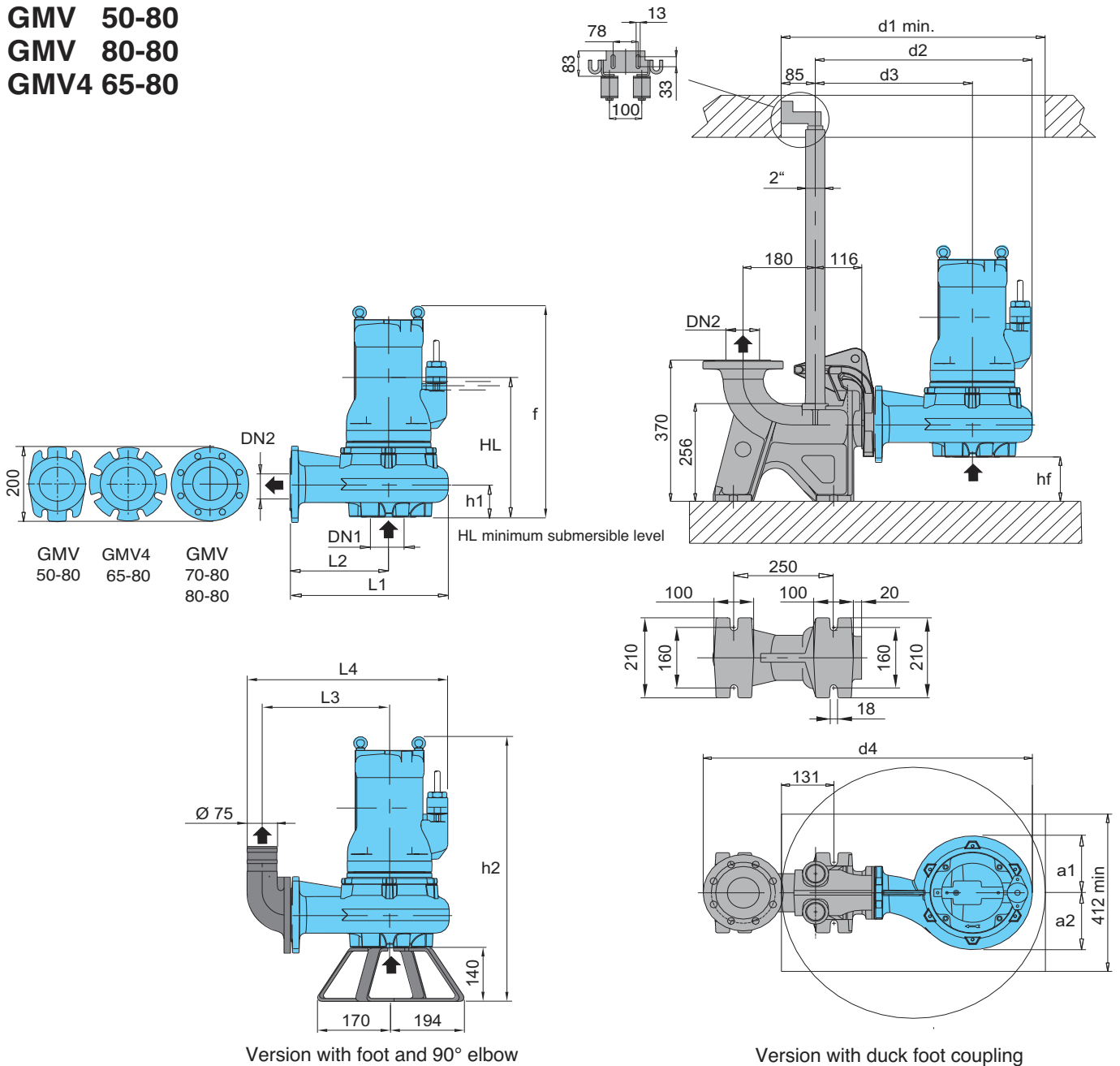

TYPE	EN 1092-2 PN 10		Dimensions mm														Weight kg	
	DN1	DN2	f	HL	hf	h1	h2	a1	a2	d1	d2	d3	d4	L1	L2	L3		L4
GMV 50-80F	80	80	487	330	116	84	627	149	149	660	541	392	821	395	246	380	570	52
GMV 50-80E			553	365	116	84	693	149	149	660	541	392	821	395	246	380	570	84
GMV 50-80D	80	80	836	516	122	78	986	164	164	800	611	428	891	445	262	334	555	190
GMV 50-80C			785	500	65	135	925	167	167	800	633	446	913	467	262	353	576	150
GMV 50-80B	80	80	863	548	60	140	1018	169	175	900	671	481	950	505	315	388	612	190
GMV 50-80A			1328	586	127	142	1478	193	193	800	672	483	952	503	280	389	614	200
GMV4 65-80D	80	80	516	380	80	121	656	143	169	700	548	396	828	402	250	323	512	64
GMV4 65-80C			575	400	80	121	715	143	169	700	548	396	828	402	250	323	512	75
GMV4 65-80B	80	80	516	380	80	121	656	143	169	700	548	396	828	402	250	323	512	64
GMV4 65-80A			575	400	80	121	715	143	169	700	548	396	828	402	250	323	512	75

Dimensions and weights

GMV4 90-100 GMV4 80-100

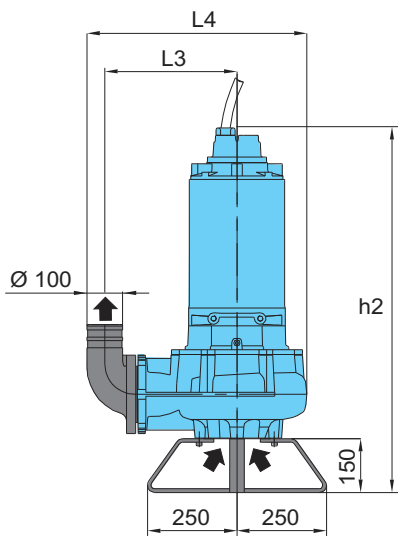
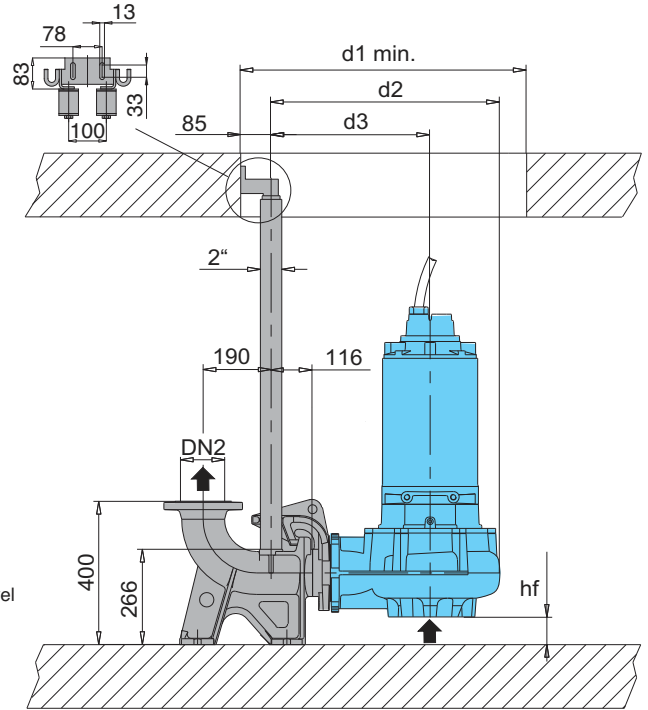
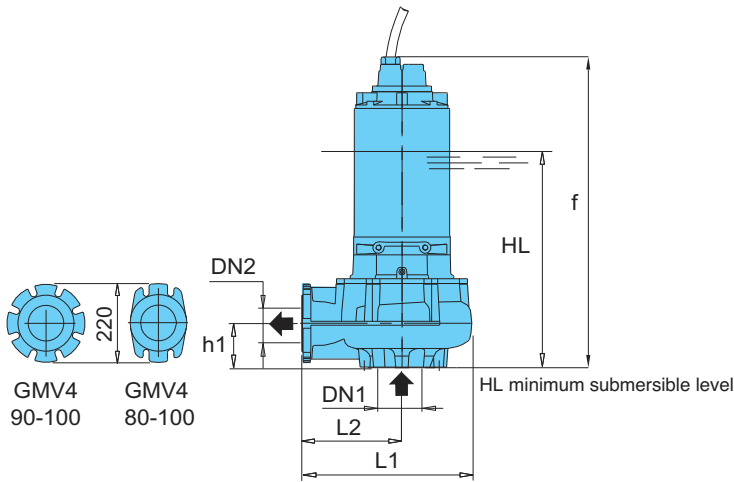

Version with foot and 90° elbow

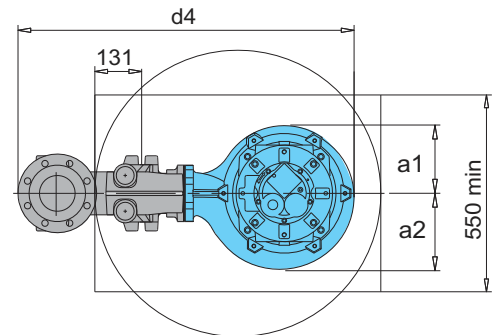
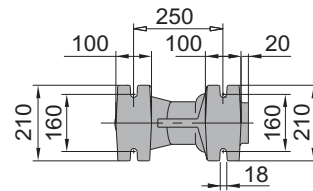

Version with duck foot coupling

TYPE	EN 1092-2 PN 10		Dimensions mm															Weight kg
	DN1	DN2	f	HL	hf	h1	h2	a1	a2	d1	d2	d3	d4	L1	L2	L3	L4	
GMV4 90-100B	125	100	785	490	89	111	935	180	180	800	633	443	933	468	277	367	607	123
GMV4 90-100A																		
GMV4 80-100C	125	100	890	570	54	147	1040	189	212	800	640	445	940	474	279	369	614	223
GMV4 80-100B																		
GMV4 80-100A																		
GMV4 80-100S	125	100	1343	670	54	146	1497	193	212	800	640	441	936	475	280	370	615	200

Dimensions and weights

GMV4 100-150

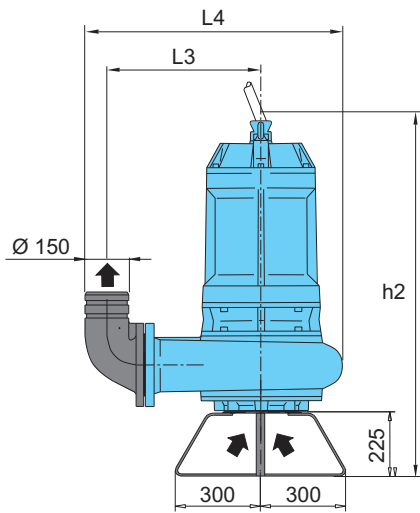
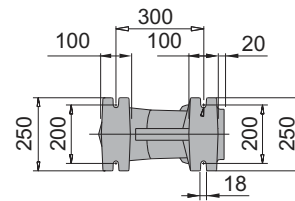
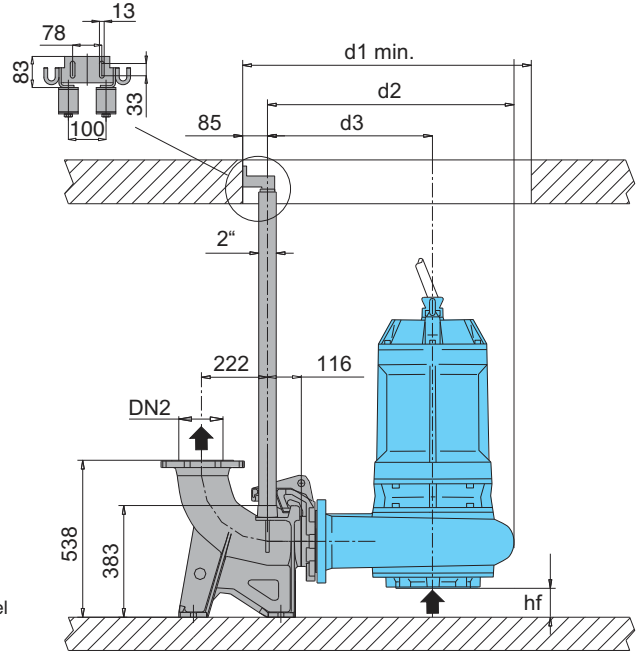
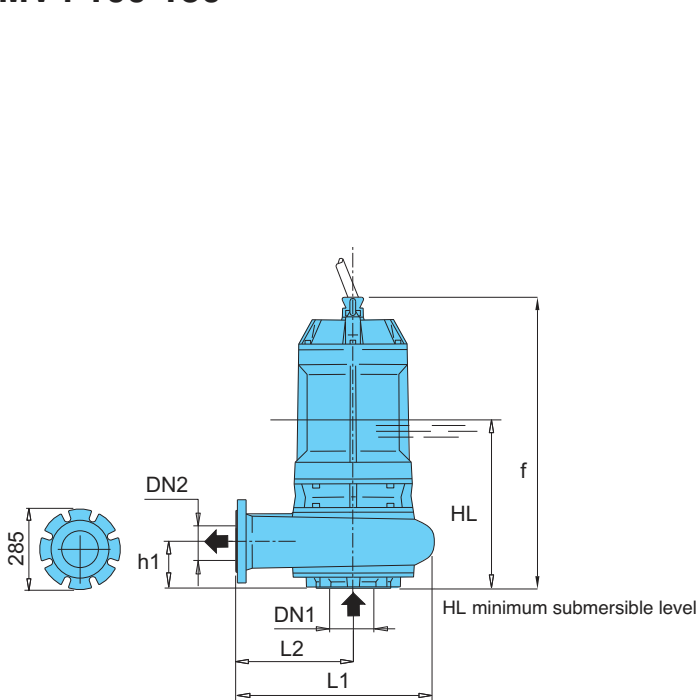

Version with foot and 90° elbow

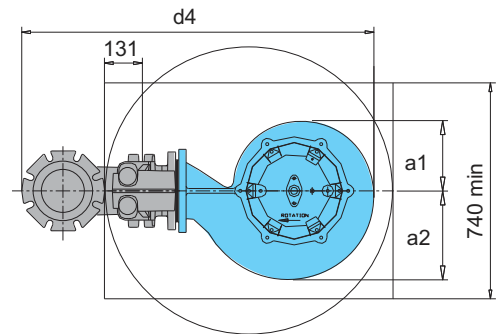

Version with duck foot coupling

TYPE	EN 1092-2 PN 10		Dimensions mm														Weight kg	
	DN1	DN2	f	HL	hf	h1	h2	a1	a2	d1	d2	d3	d4	L1	L2	L3		L4
GMV4 100-150E	150	150	1359	710	114	146	1581	193	223	850	675	469	1040	486	280	431	712	290
GMV4 100-150B	150	150	1014	592	135	143	1236	264	264	1000	880	616	1249	714	450	580	919	361
GMV4 100-150A																		