



Budowa

Korpus pompy z brązu, z króćcami ssawnymi i tłocznymi tej samej średnicy i rozmieszczone wzdłuż tej samej osi (in-line).

Materiały

Korpus pompy	Zelazo
Wirnik	Stal nierdzewna
Wał	Stal nierdzewna

Zastosowania

- dla płynów czystych, bez materiałów ściernych, które nie oddziałują szkodliwie na materiały pompy (dopuszczalna zawartość ciał stałych do 0,2 %),
- dla urządzeń grzewczych, klimatyzacyjnych, chłodniczych i obiegowych,
- dla przemysłu i gospodarstw domowych,

Warunki pracy pompy

- Temperatura płynu od -10°C do +120 °C (chwilowo: do +140 °C)
- Temperatura otoczenia do +40 °C.
- maksymalne stężenie glikolu: 50% (roztwór glikolu o większym stężeniu niż 20% wymaga ponownego sprawdzenia parametrów pompy)
- Maksymalne dopuszczalne ciśnienie przy pracy pompy: 6/10 barów.

Silnik

Silnik indukcyjny dwu-, lub czterobiegunowy, 50 Hz.
Trzy ustawialne prędkości.
NC: trójfazowy 230 V lub 400 V.
NCM: jednofazowy 230 V
Klasa izolacji: H.
Stopień ochrony: IP 43

Typ	Minimalne ciśnienie ssania: bary		
	50 °C	Temperatura 80 °C	110 °C
NC 40	0,05	0,8	1,4
NC 50	0,3	1	1,6
NC 65	0,3	1	1,6
NC 80	0,3	1	1,6

Installation

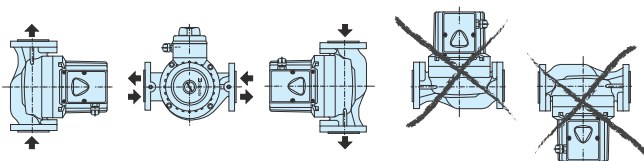

Cross section drawings

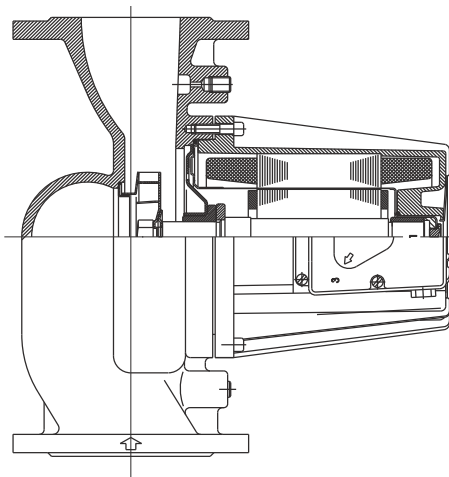

Designation

NC (M) 4 40 - 60 / 250

Typ _____
silnik jednofazowy _____
silnik indukcyjny czterobiegunowy _____
średnica kroćcy DN w mm _____
Max. wys. podnoszenia w dm _____
Odległość między przyłączami w mm _____

Coverage chart

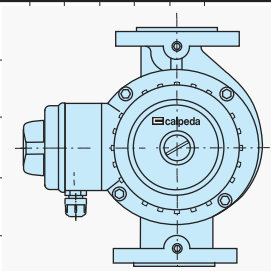
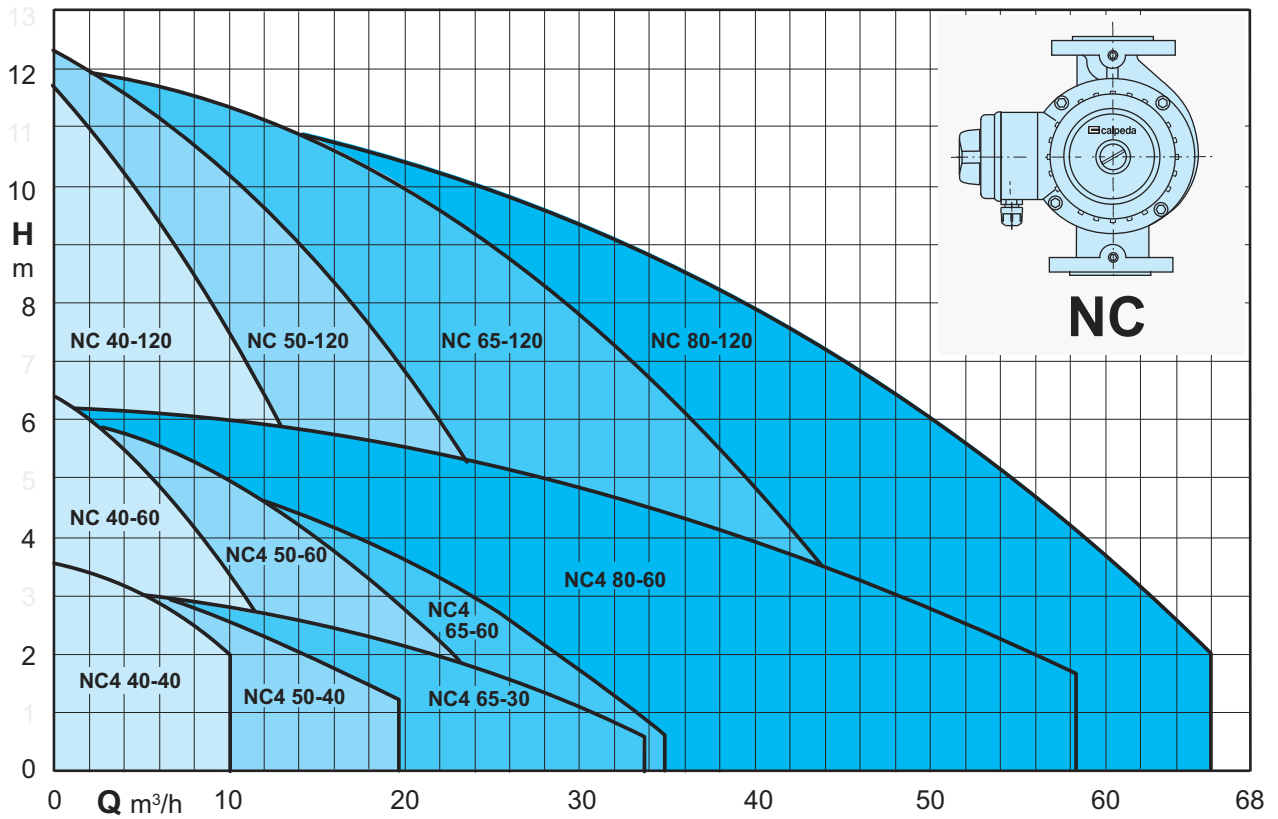

NC

Tolerances according to ISO 9906, annex A.

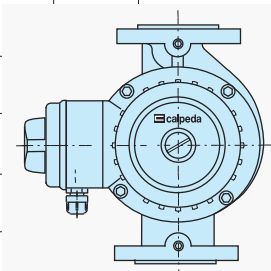
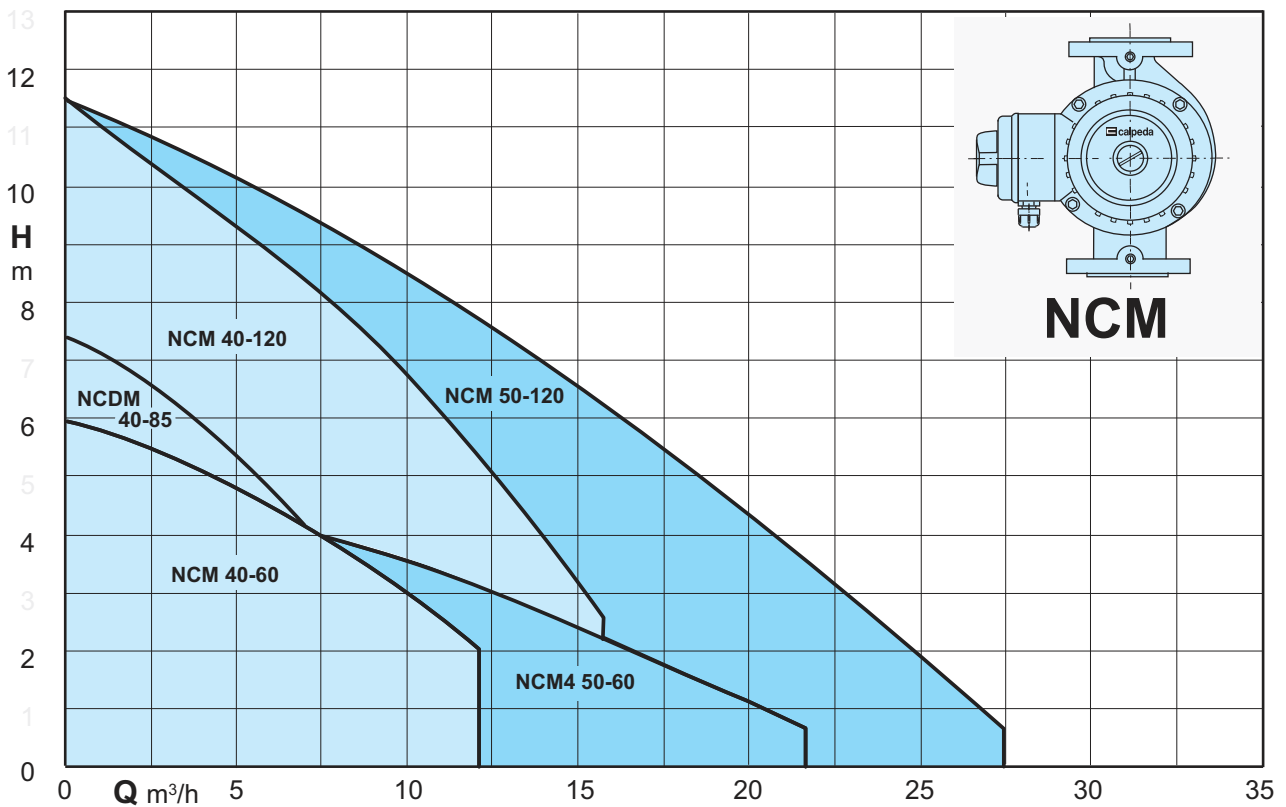

NCM

Tolerances according to ISO 9906, annex A.

Characteristic curves, dimensions and weights

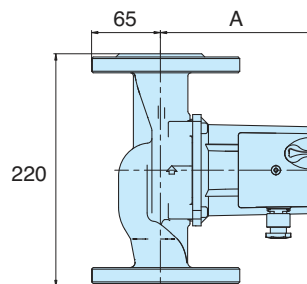
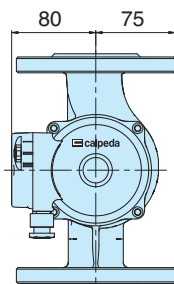
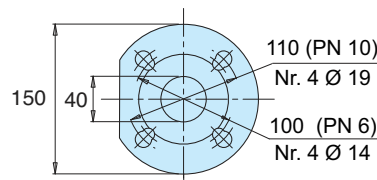
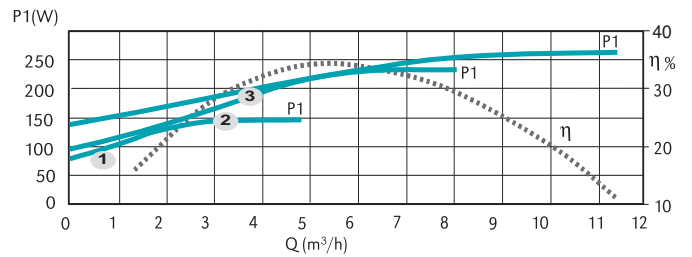
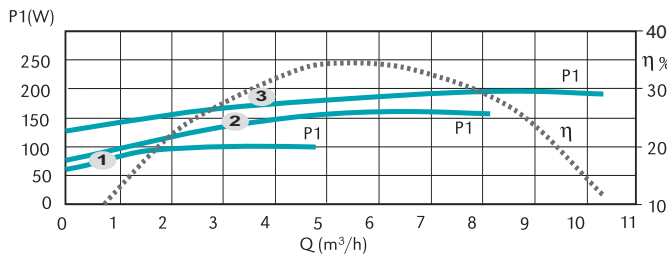
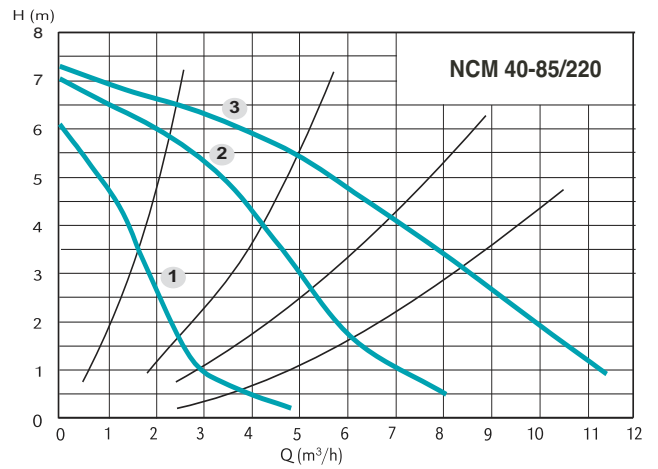
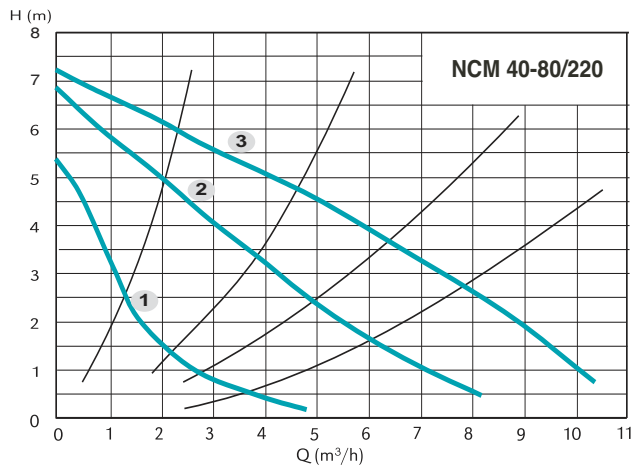

TYPE	DN PN		N° Poli		Pos.	P1 (W)	1x 230 V [A]	A [mm]	[kg]
	DN	PN	2	4					
NCM 40-80/220	40	6/10	✓		3	206	0,91	150	8,1
					2	185	0,88		
					1	120	0,60		
NCM 40-85/220	40	6/10	✓		3	277	1,20	175	8,8
					2	250	1,16		
					1	172	0,85		

Characteristic curves, dimensions and weights

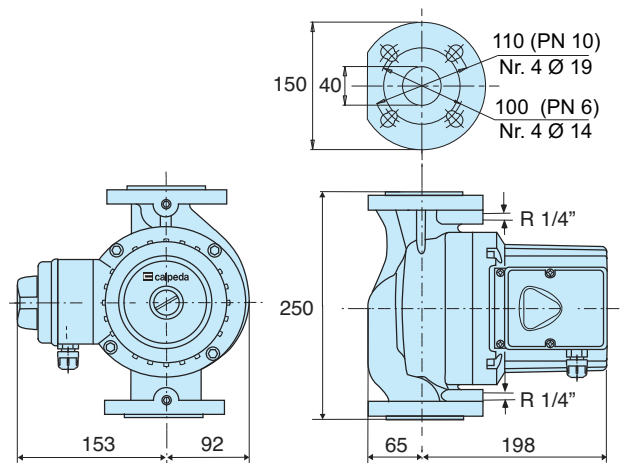
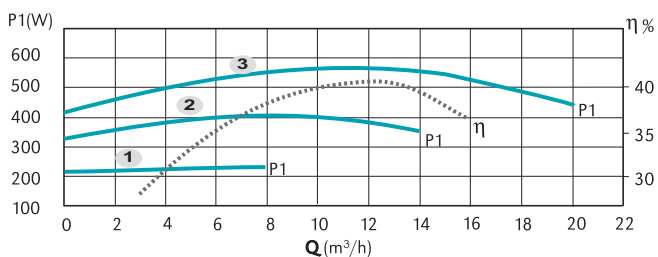
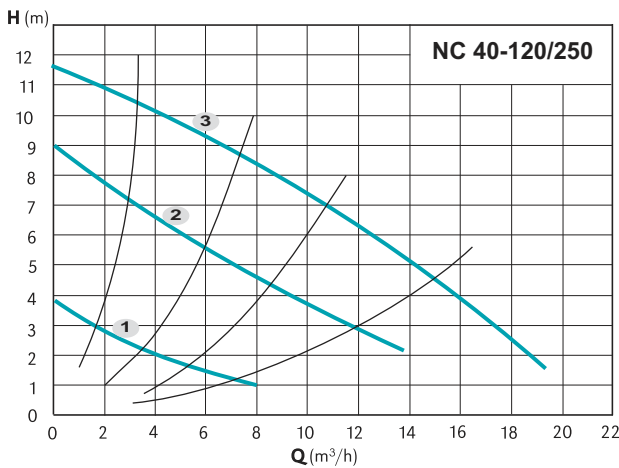
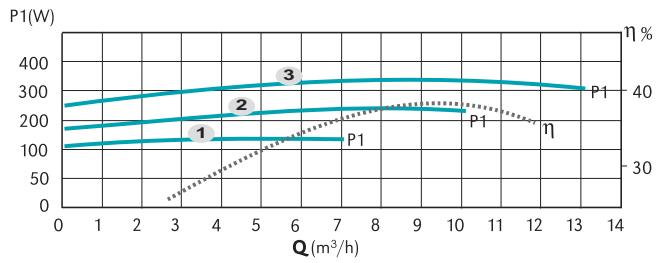
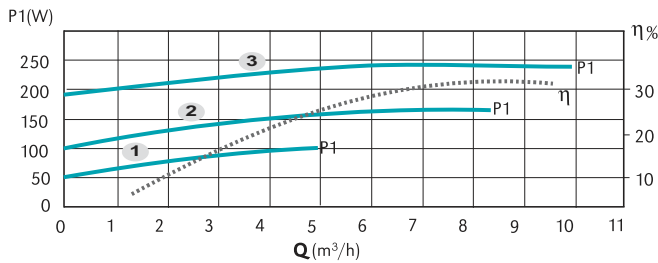
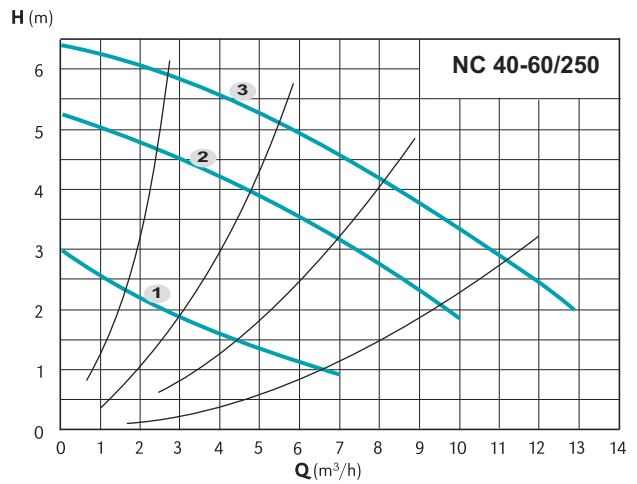
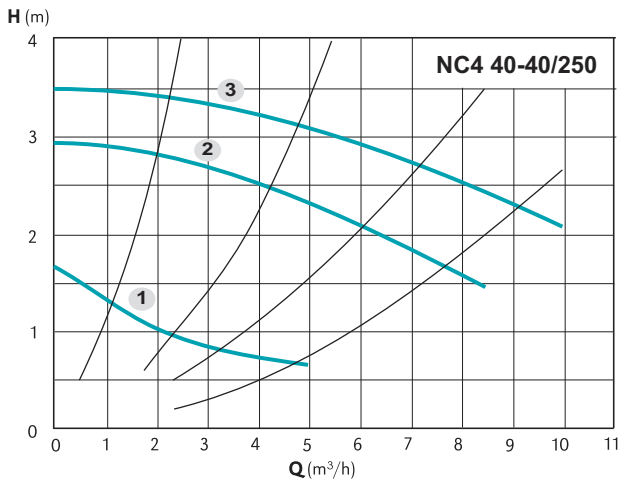

TYPE	DN	PN	N° Poli	Pos.	1/min	P1 (W)	3x 400 V [A]	[kg]
NC4 40-40/250	40	6/10	✓	3	1440	240	0,76	17,0
				2	1200	160	0,24	
				1	660	100	0,11	
NC 40-60/250	40	6/10	✓	3	2790	320	0,74	17,5
				2	2240	240	0,36	
				1	1440	140	0,18	
NC 40-120/250	40	6/10	✓	3	2820	560	1,16	19,0
				2	2200	400	0,64	
				1	1250	220	0,26	

Characteristic curves, dimensions and weights

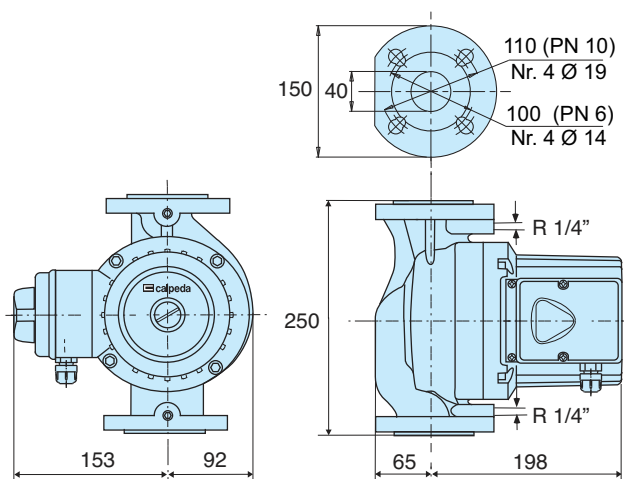
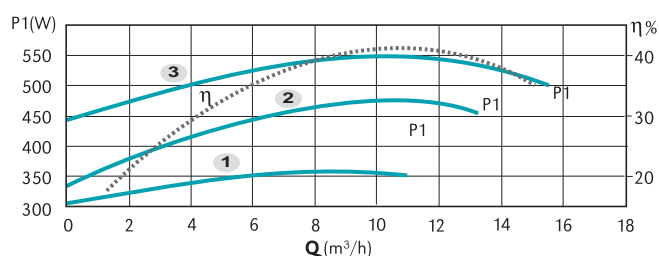
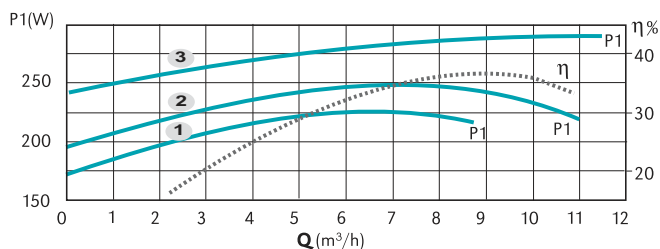
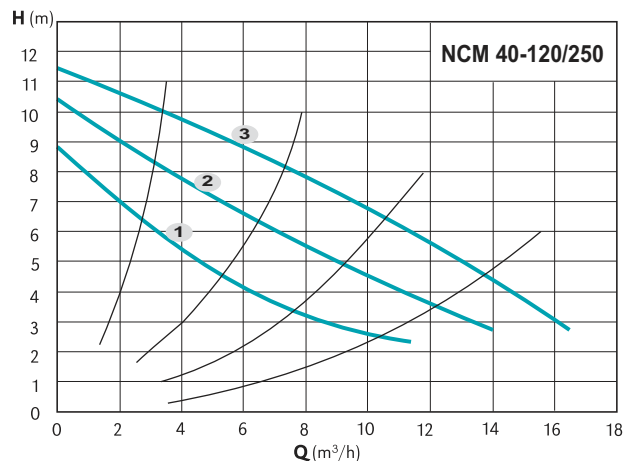
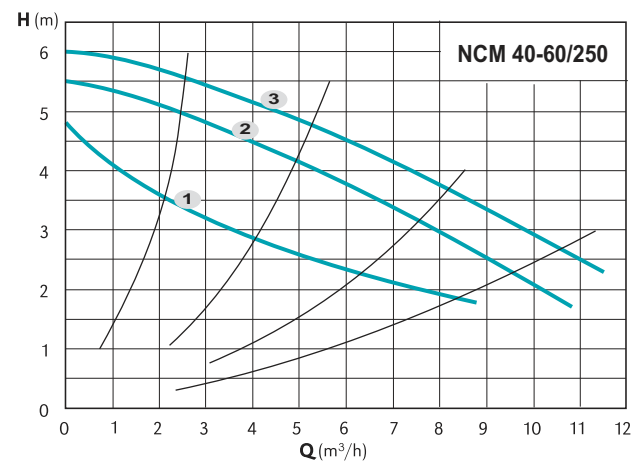

TYPE	DN PN		N° Poli 2 4	Pos.	1/min	P1 (W)	1x 230 V [A]	[kg]
	DN	PN						
NCM 40-60/250	40	6/10	✓	3	2690	285	1,20	17,5
				2	2360	245	1,18	
				1	1820	225	1,15	
NCM 40-120/250	40	6/10	✓	3	2750	550	2,35	19,0
				2	2100	475	2,30	
				1	1270	355	1,85	

Characteristic curves, dimensions and weights

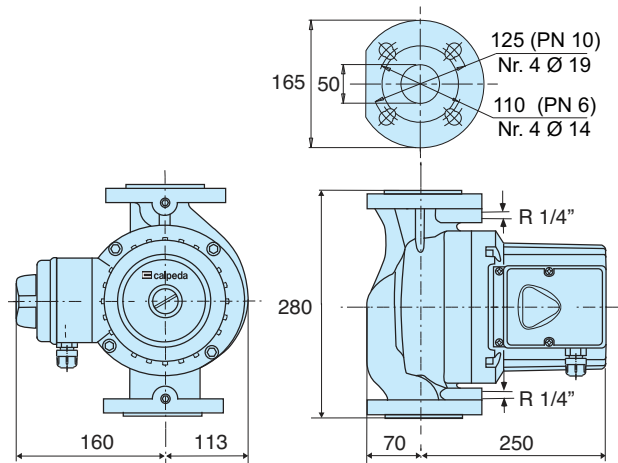
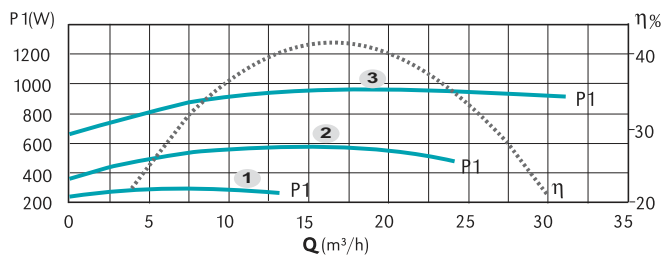
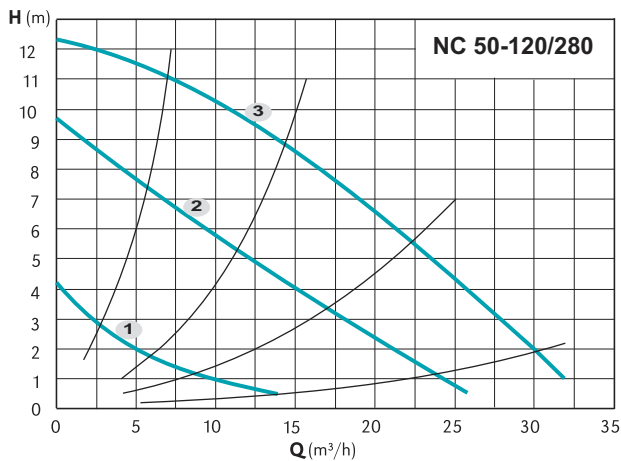
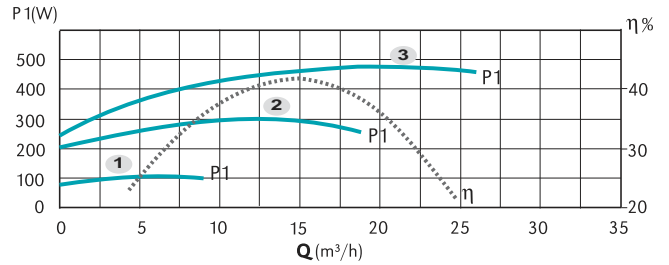
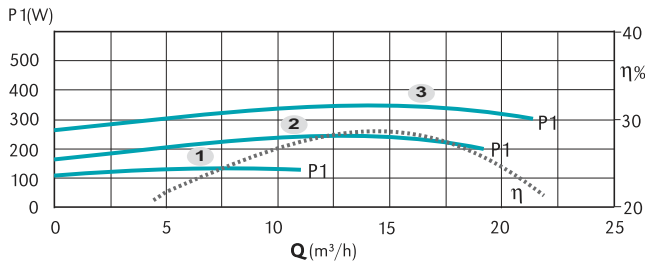
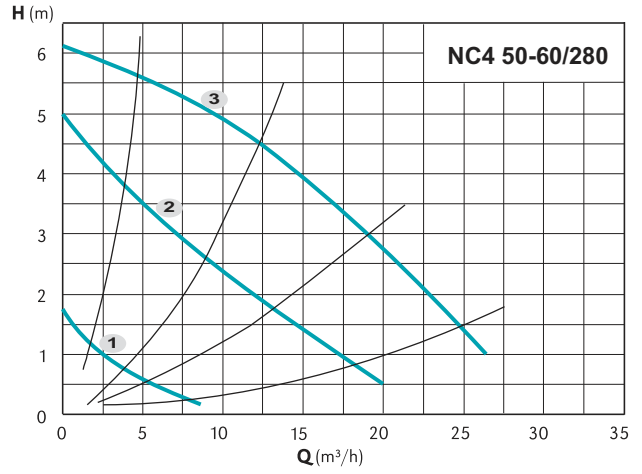
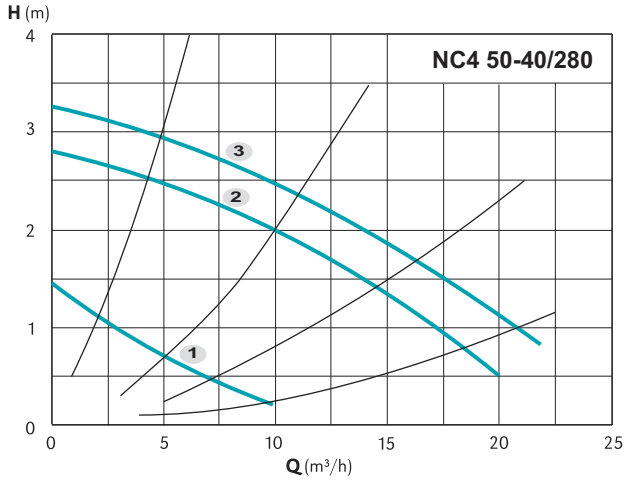

TYPE	DN	PN	N° Poli		Pos.	1/min	P1 (W)	3x 400 V [A]	[kg]
			2	4					
NC4 50-40/280	50	6/10	✓		3	1450	340	1,05	24,0
						620	120	0,22	
NC4 50-60/280	50	6/10	✓		3	1400	470	1,15	24,0
						1000	300	0,55	
NC 50-120/280	50	6/10	✓		3	2800	950	1,73	24,0
						2330	540	1,05	
					1	1270	265	0,46	

Characteristic curves, dimensions and weights

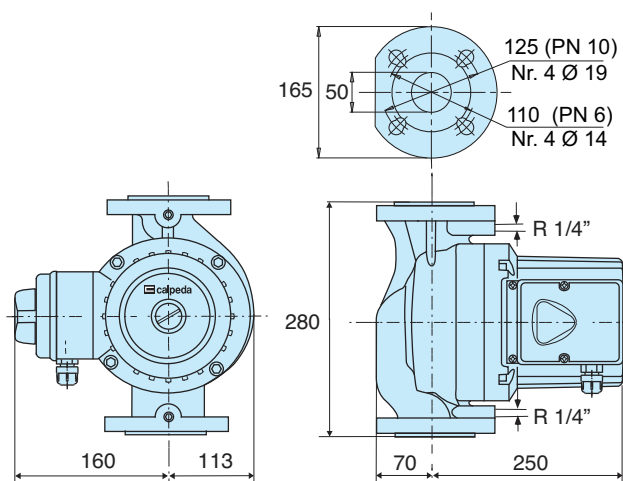
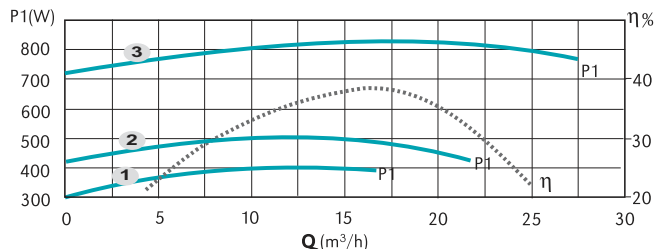
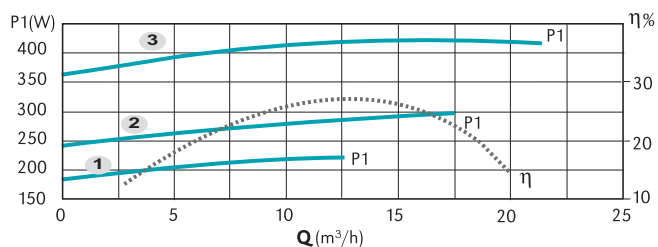
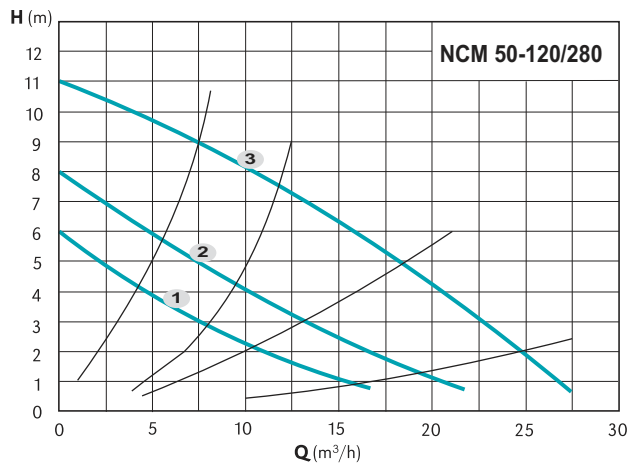
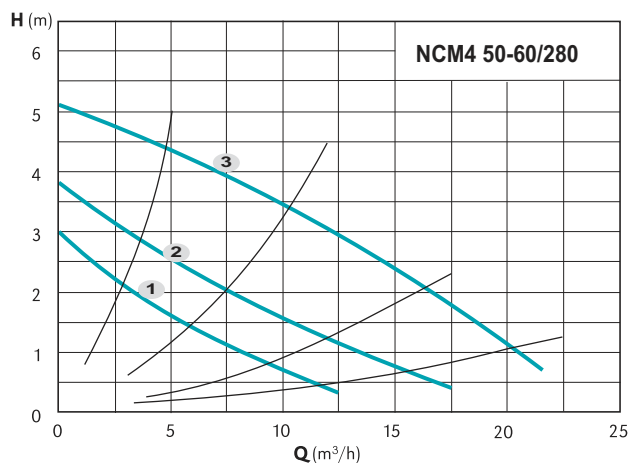

TYPE	DN PN		N° Poli		Pos.	1/min	P1 (W)	1x 230 V [A]	[kg]
	2	4	2	4					
NCM4 50-60/280	50	6/10	✓	3	1260	415	1,8	24,5	
				2	1030	300	1,3		
				1	740	230	1,0		
NCM 50-120/280	50	6/10	✓	3	2720	830	3,6	24,5	
				2	1870	480	2,1		
				1	1450	390	1,7		

Characteristic curves, dimensions and weights

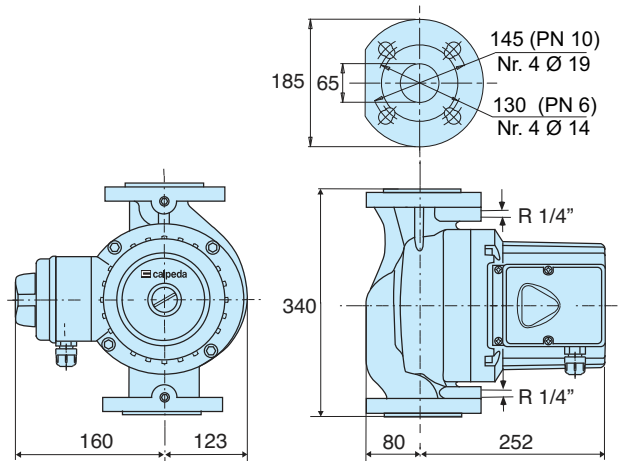
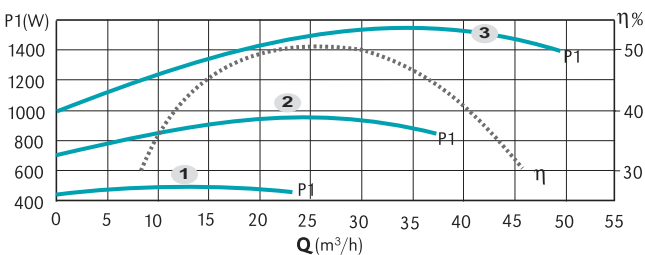
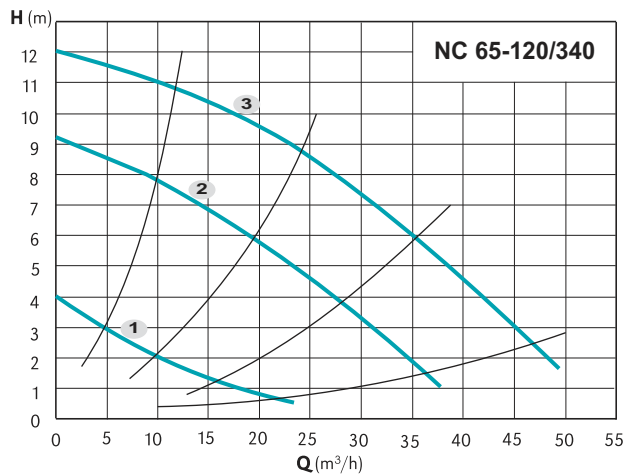
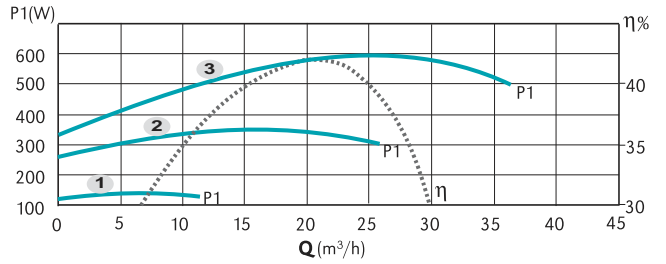
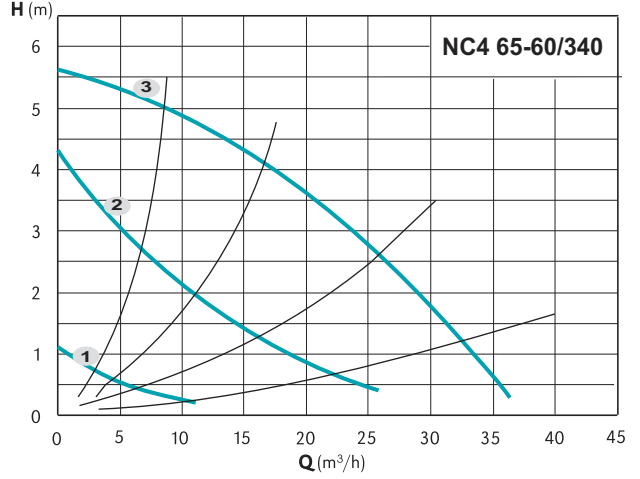
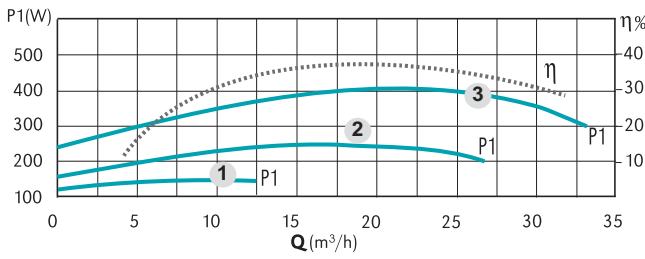
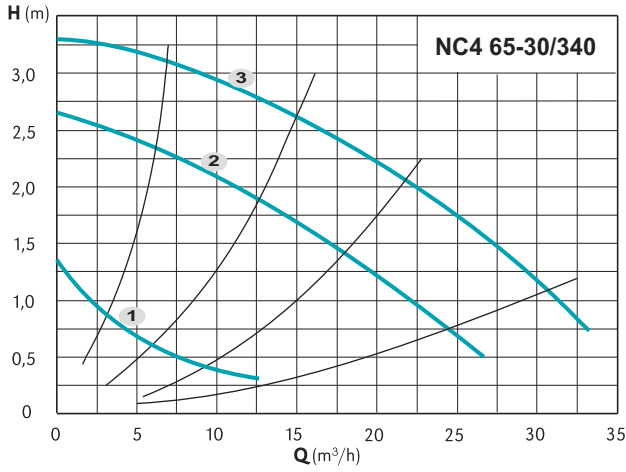

TYPE	DN PN		N° Poli 2 4	Pos.	1/min	P1 (W)	3x 400 V [A]	[kg]
	DN	PN						
NC4 65-30/340	65	6/10	✓	3	1430	400	1,10	29,0
				2	1150	260	0,50	
				1	600	120	0,22	
NC4 65-60/340	65	6/10	✓	3	1370	600	1,25	29,0
				2	950	360	0,64	
				1	450	120	0,22	
NC 65-120/340	65	6/10	✓	3	2810	1560	2,80	31,0
				2	2200	960	1,70	
				1	1250	460	0,84	

Characteristic curves, dimensions and weights

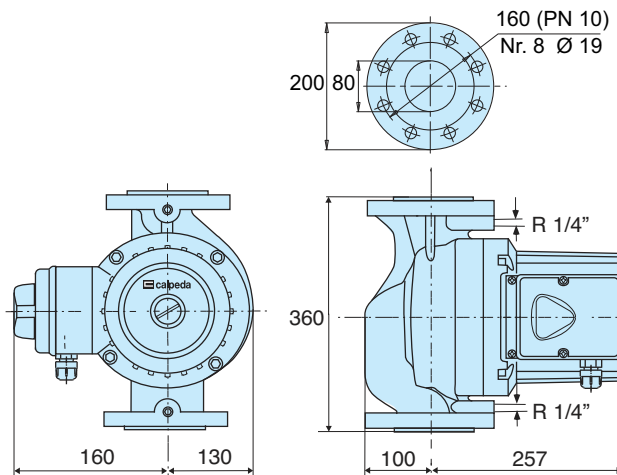
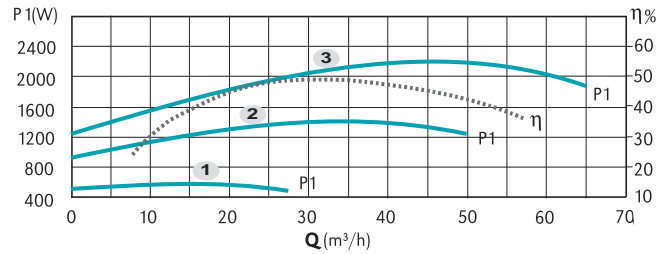
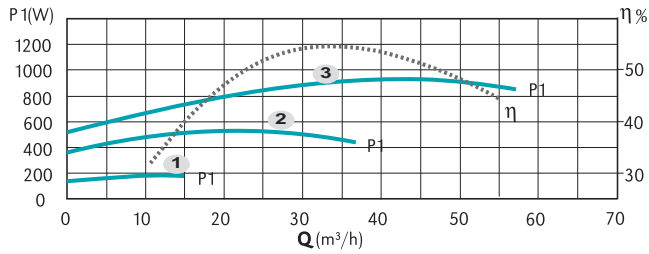
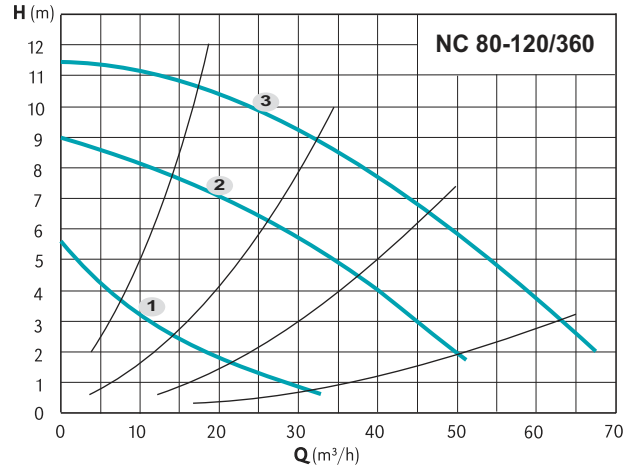
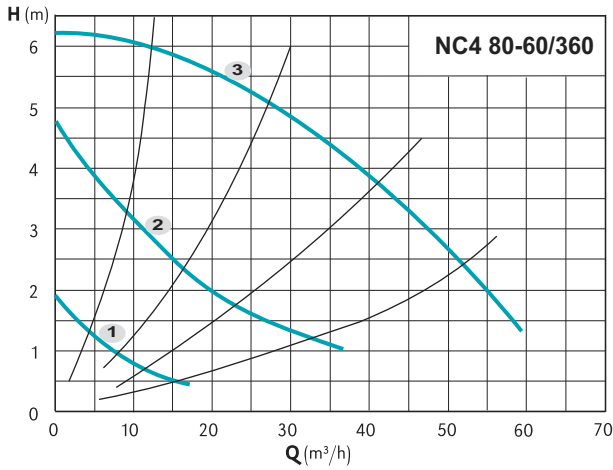

TYPE	DN	PN	N° Poli		Pos.	1/min	P1 (W)	3x 400 V [A]	[kg]
			2	4					
NC4 80-60/360	80	10		✓	3	1350	960	2,20	33,5
					2	1000	560	1,10	
					1	600	200	0,38	
NC 80-120/360	80	10	✓		3	2800	2200	3,80	34,5
					2	2160	1400	2,40	
					1	1200	550	1,05	