



## Budowa

Korpus pompy z króćcami ssawnymi i tłocznymi tej samej średnicy i rozmieszczone wzdłuż tej samej osi (in-line).

## Materiały

Obudowa pompy	Zeliwo
Wirnik	Stal nierdzewna
Wał	Stal nierdzewna

## Zastosowania

- dla płynów czystych, bez materiałów ścierających, które nie oddziałują szkodliwie na materiały pompy (dopuszczalna zawartość ciał stałych do 0,2 %),
- dla urządzeń grzewczych, klimatyzacyjnych, chłodniczych i obiegowych,
- dla przemysłu i gospodarstw domowych,
- jeśli wymagany jest niski poziom hałasu pracującej pompy.

## Warunki pracy pompy

- Temperatura płynu od -10°C do +120 °C (chwilowo: do +140 °C)
- Temperatura otoczenia do +40 °C.
- maksymalne stężenie glikolu: 50% (roztwór glikolu większy niż 20% wymaga ponownego sprawdzenia parametrów pompy)
- Maksymalne dopuszczalne ciśnienie przy pracy pompy: 6/10 barów.

## Silnik

Silnik indukcyjny dwu-, lub czterobiegunowy 50 Hz.  
Trzy ustawialne prędkości.  
NCD: trójfazowy 230 V lub 400 V.  
NCDM: jednofazowy 230 V  
Klasa izolacji: H.  
Stopień ochrony: IP 43.

Typ	Minimalne ciśnienie ssania: bary		
	50 °C	Temperatura 80 °C	110 °C
NCD 40	0,05	0,8	1,4
NCD 50	0,3	1	1,6
NCD 65	0,3	1	1,6
NCD 80	0,3	1	1,6

## Działanie

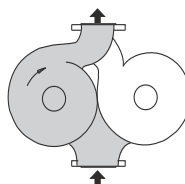

### Pojedyncze

Praca pojedynczej pompy wybranej przez klienta, z drugą pompą w stanie czuwania

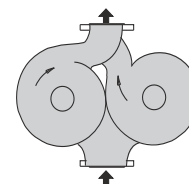

### Podwójne

Operacja z równoległym wykorzystaniem obu pomp

## Installation

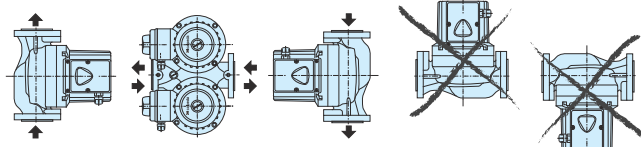

## Cross section drawings

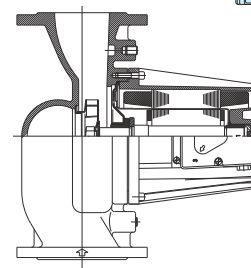

## Designation

NC D (M) 4 40 - 60 / 250

Typ \_\_\_\_\_  
Pompy bliźniacze \_\_\_\_\_  
Silnik jednofazowy \_\_\_\_\_  
Silnik indukcyjny czterobiegunowy \_\_\_\_\_  
średnica przyłączy w DM mm \_\_\_\_\_  
max. wysokość podnoszenia w dm \_\_\_\_\_  
odległość między przyłączeniami w mm \_\_\_\_\_

## Coverage chart

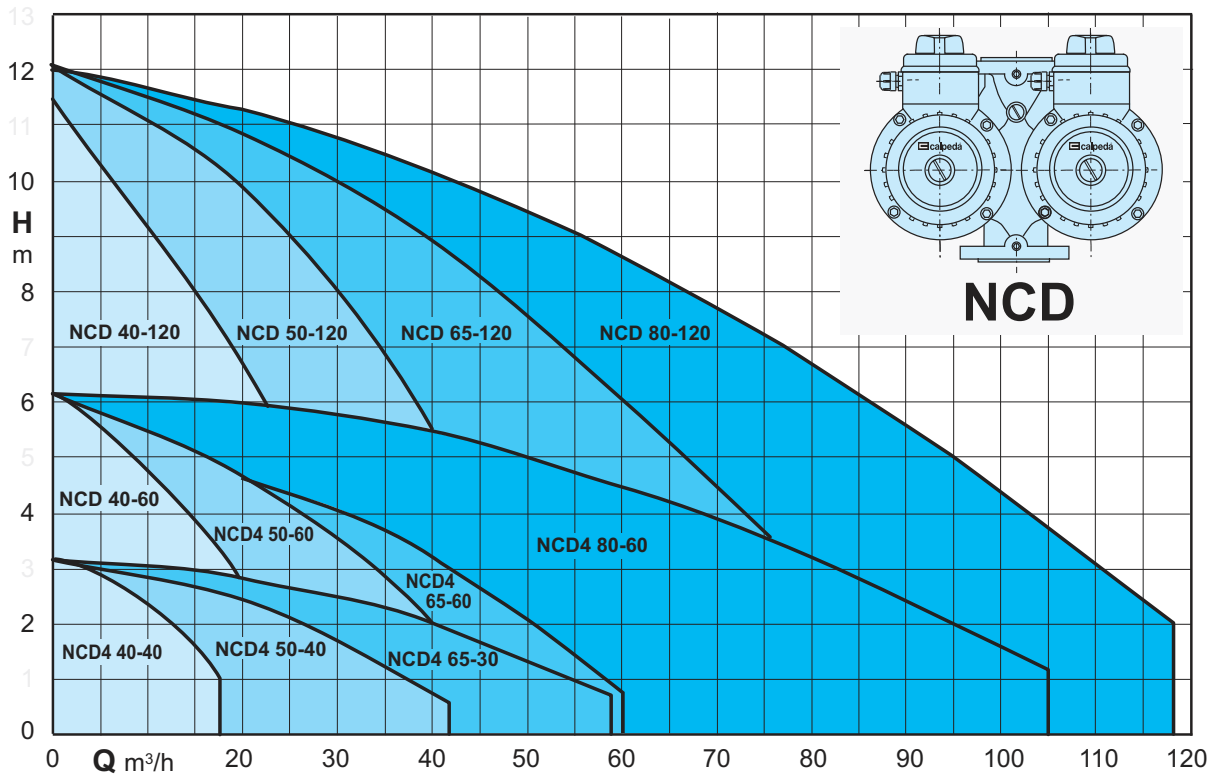

Tolerances according to ISO 9906, annex A.

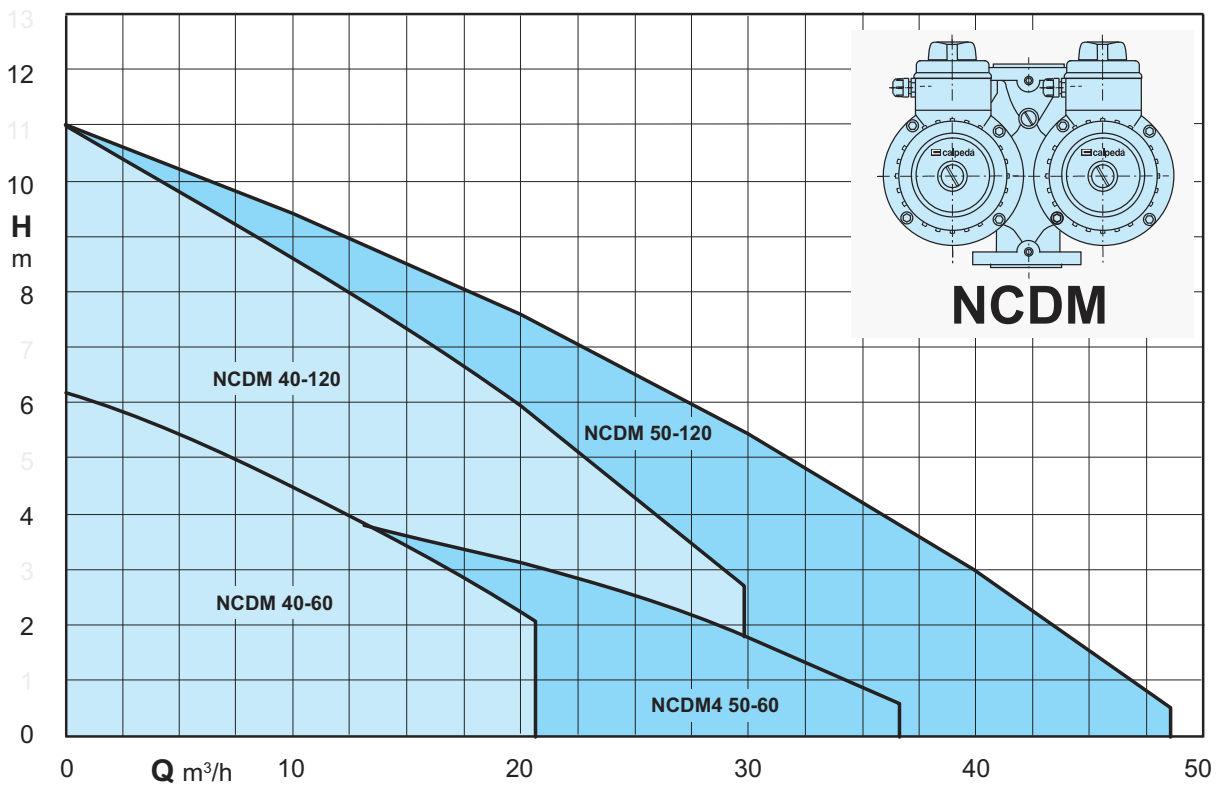

Tolerances according to ISO 9906, annex A.

### Characteristic curves, dimensions and weights

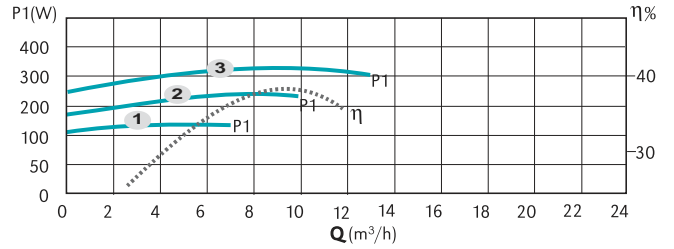
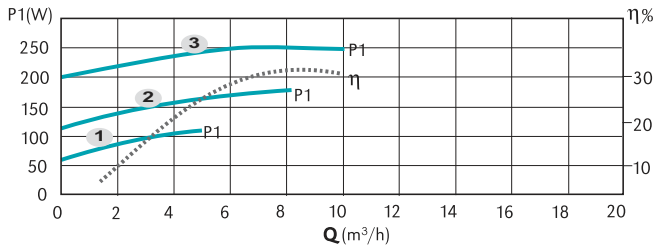
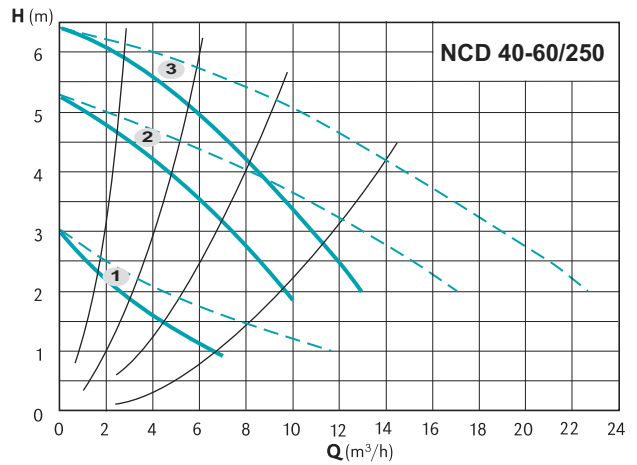
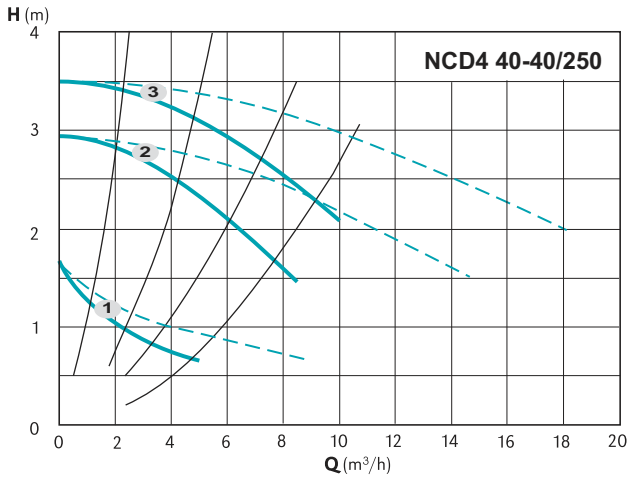

— Single operation  
- - - Operation in parallel

— Single operation  
- - - Operation in parallel

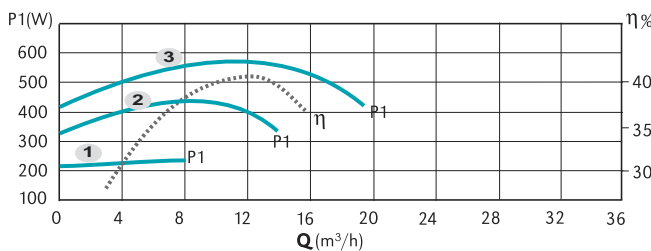
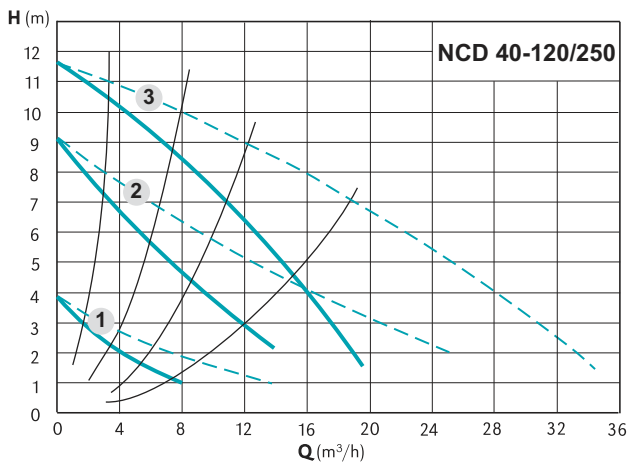

— Single operation  
- - - Operation in parallel

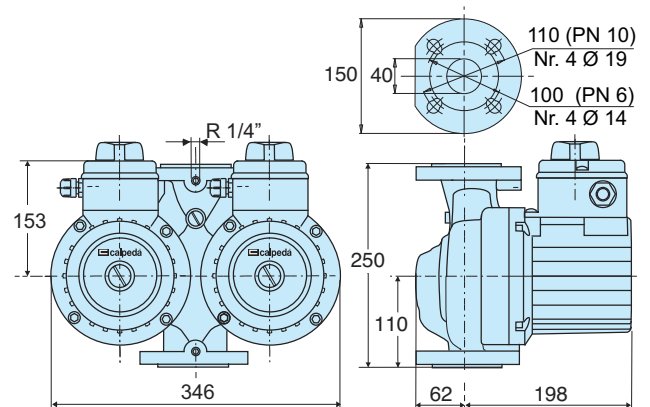

TYPE	DN	PN	N° Poli 2 4	Pos.	1/min	P1 (W)	3x 400 V [A]	[kg]
NCD4 40-40/250	40	6/10	✓	3	1440	240	0,76	34,0
				2	1200	160	0,24	
				1	660	100	0,11	
NCD 40-60/250	40	6/10	✓	3	2790	320	0,74	35,0
				2	2240	240	0,36	
				1	1440	140	0,18	
NCD 40-120/250	40	6/10	✓	3	2820	560	1,16	35,0
				2	2200	400	0,64	
				1	1250	220	0,26	

### Characteristic curves, dimensions and weights

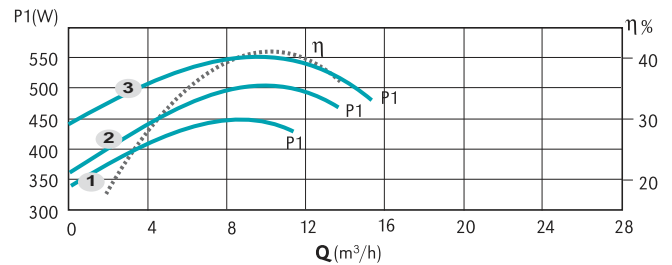
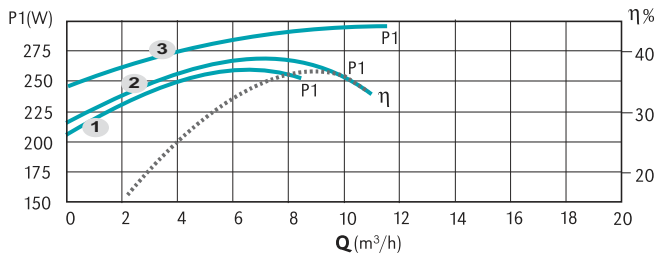
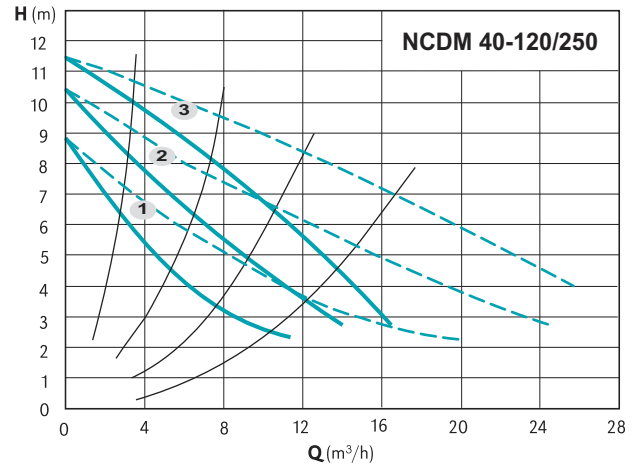
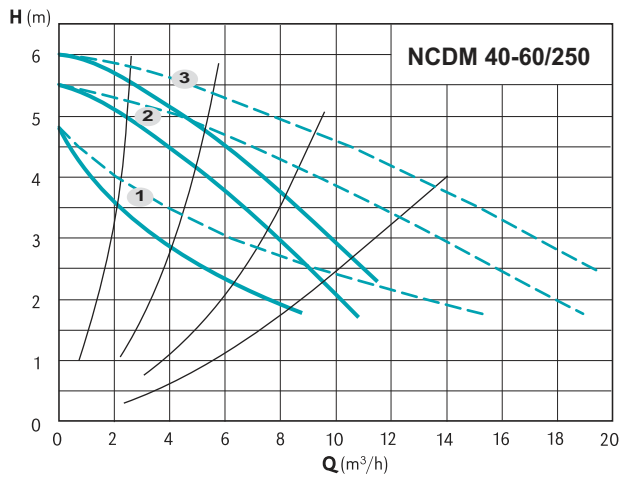

— Single operation  
- - - Operation in parallel

— Single operation  
- - - Operation in parallel

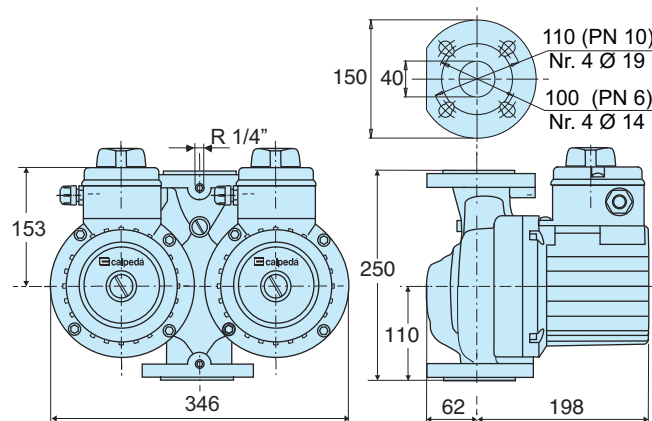

TYPE	DN   PN		N° Poli 2   4	Pos.	1/min	P1 (W)	1x 230 V [A]	[kg]
	40	6/10						
NCDM 40-60/250			✓	3	2690	285	1,20	35,0
				2	2360	245	1,18	
				1	1820	225	1,15	
NCDM 40-120/250			✓	3	2755	550	2,35	35,0
				2	2100	475	2,30	
				1	1270	355	1,85	

### Characteristic curves, dimensions and weights

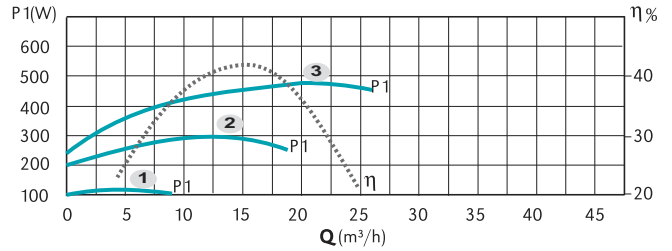
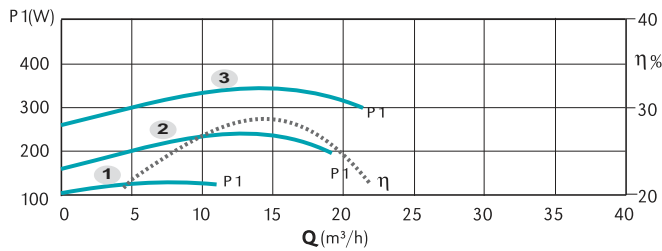
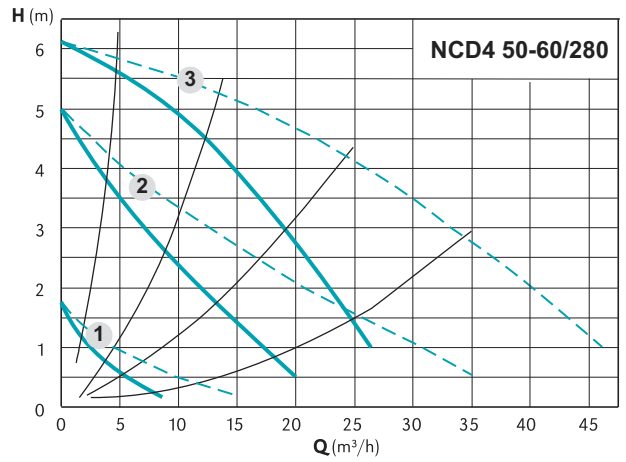
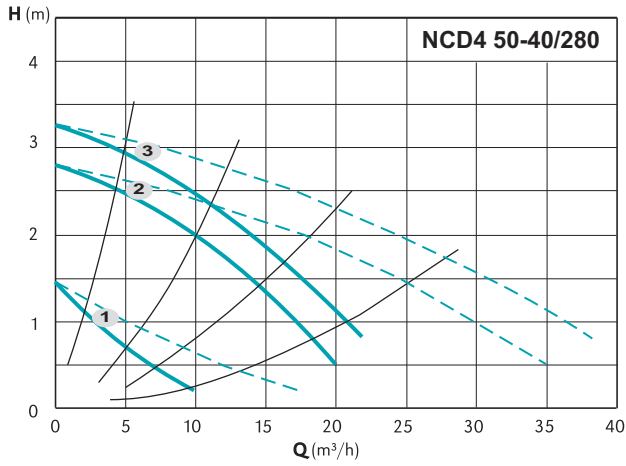

— Single operation  
- - - Operation in parallel

— Single operation  
- - - Operation in parallel

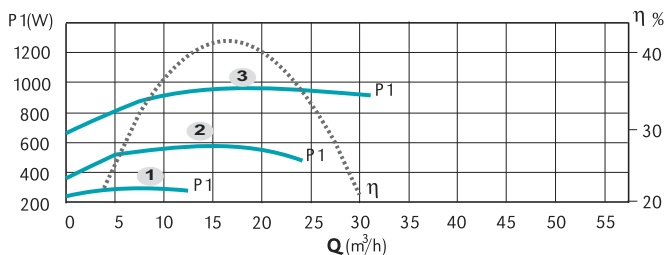
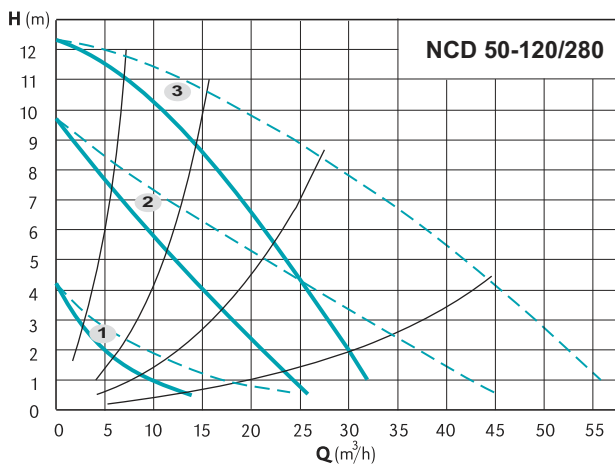

— Single operation  
- - - Operation in parallel

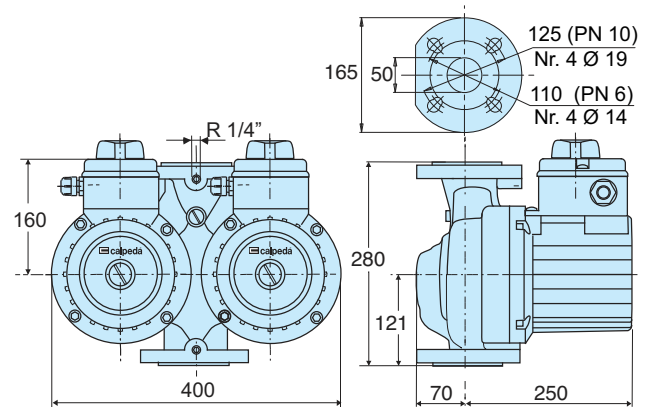

TYPE	DN	PN	N° Poli 2   4	Pos.	1/min	P1 (W)	3x 400 V [A]	[kg]
NCD4 50-40/280	50	6/10	✓	3	1450	340	1,05	44,0
				2	1220	240	0,44	
				1	620	120	0,22	
NCD4 50-60/280	50	6/10	✓	3	1400	470	1,15	44,0
				2	1000	300	0,55	
				1	560	100	0,20	
NCD 50-120/280	50	6/10	✓	3	2800	950	1,73	44,0
				2	2330	540	1,05	
				1	1270	265	0,46	

### Characteristic curves, dimensions and weights

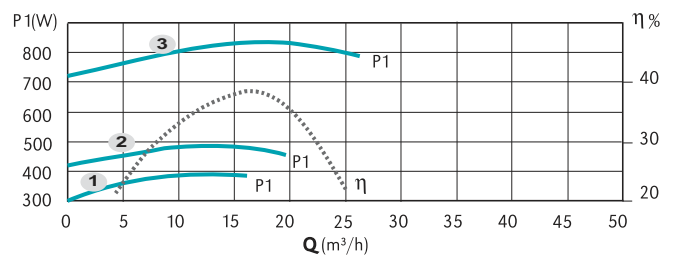
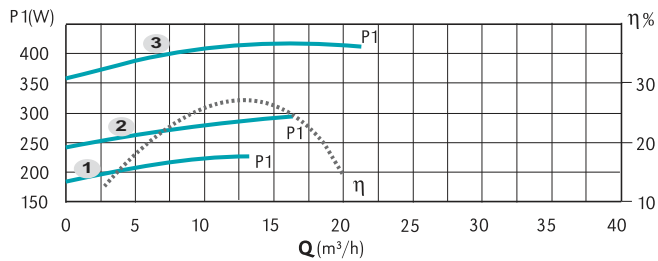
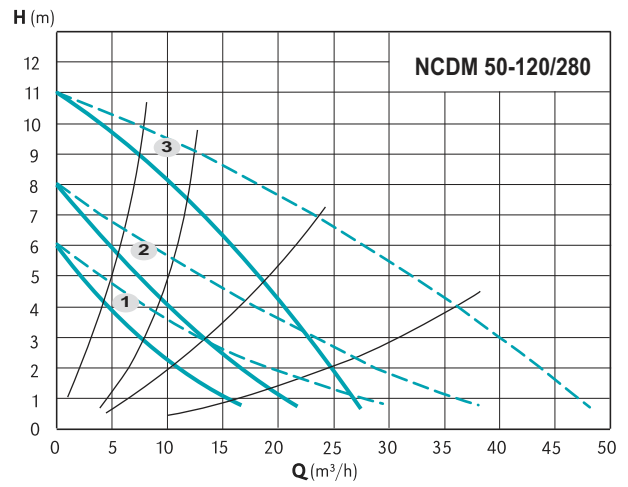
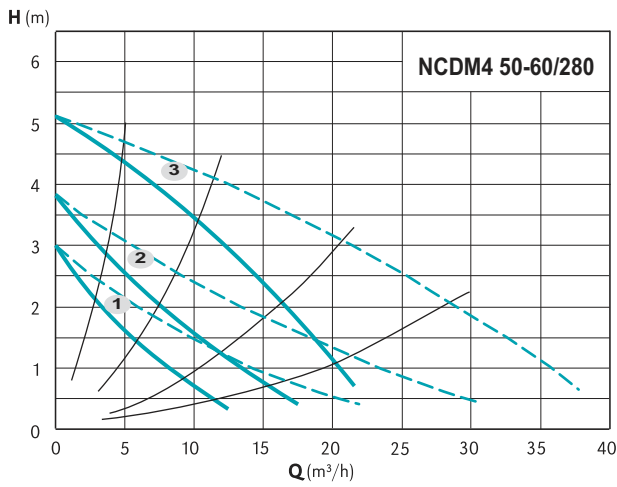

——— Single operation  
- - - - - Operation in parallel

——— Single operation  
- - - - - Operation in parallel

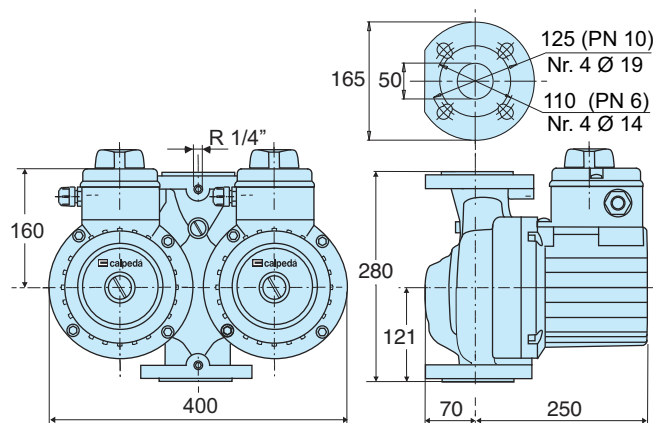

TYPE	DN	PN	N° Poli		Pos.	1/min	P1 (W)	1x 230 V [A]	[kg]
			2	4					
NCDM4 50-60/280	50	6/10	✓	3	1260	415	1,8	44,0	
				2	1030	300	1,3		
				1	740	230	1,0		
NCDM 50-120/280	50	6/10	✓	3	2720	830	3,6	44,0	
				2	1870	480	2,1		
				1	1450	390	1,7		

### Characteristic curves, dimensions and weights

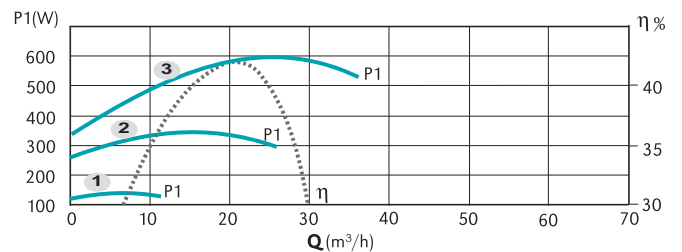
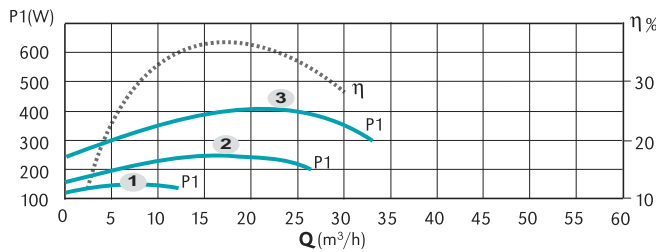
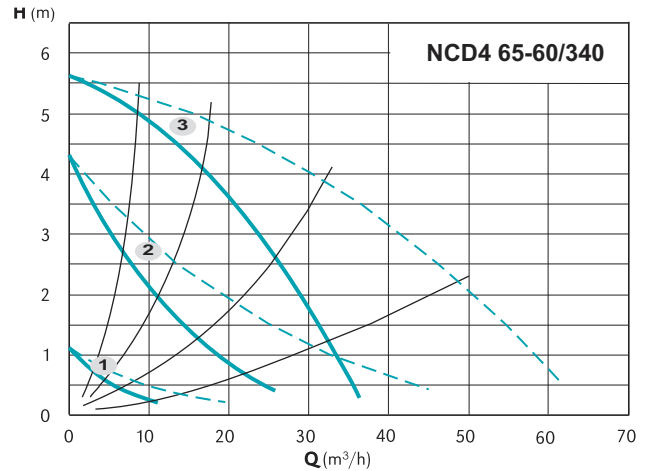
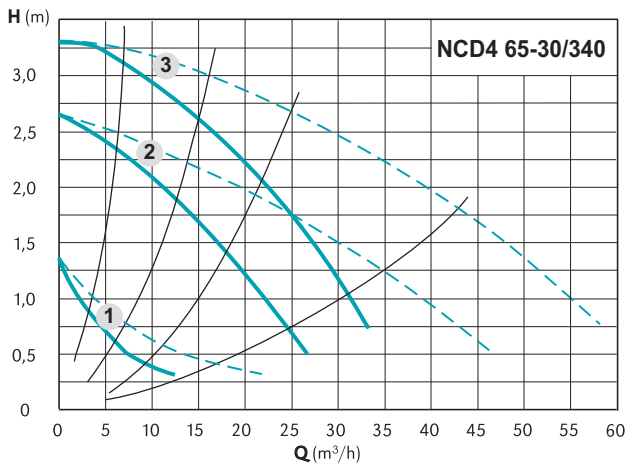

— Single operation  
- - - Operation in parallel

— Single operation  
- - - Operation in parallel

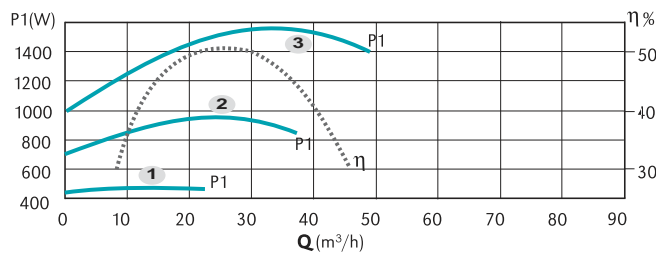
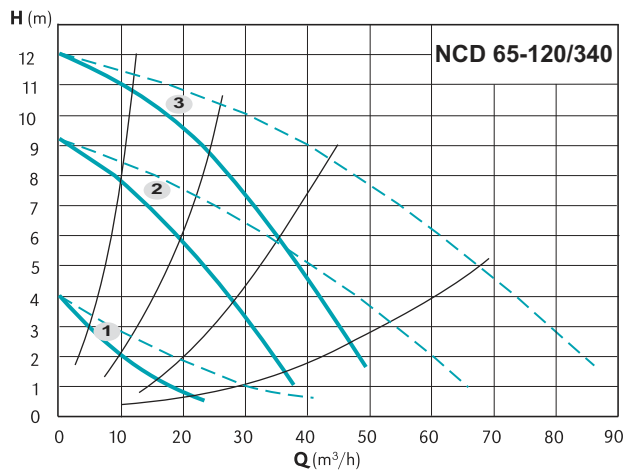

— Single operation  
- - - Operation in parallel

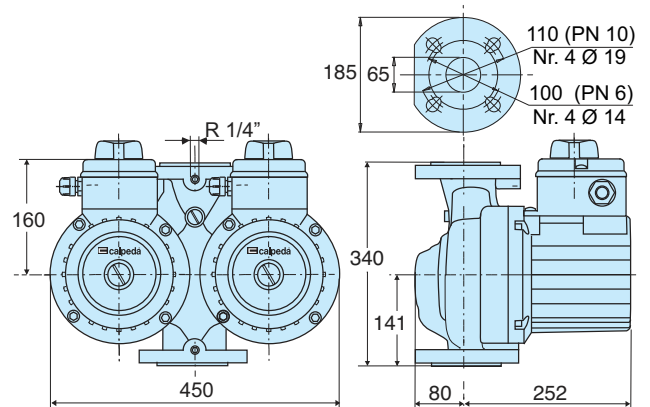

TYPE	DN	PN	N° Poli 2   4	Pos.	1/min	P1 (W)	3x 400 V [A]	[kg]
NCD4 65-30/340	65	6/10	✓	3	1430	400	1,10	49,0
				2	1150	260	0,50	
				1	600	120	0,22	
NCD4 65-60/340	65	6/10	✓	3	1370	600	1,25	49,0
				2	950	360	0,64	
				1	450	120	0,22	
NCD 65-120/340	65	6/10	✓	3	2810	1560	2,80	54,0
				2	2200	960	1,70	
				1	1250	460	0,84	

### Characteristic curves, dimensions and weights

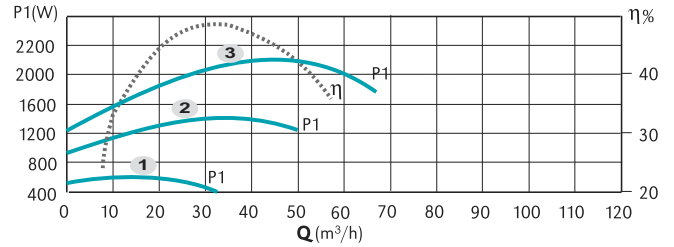
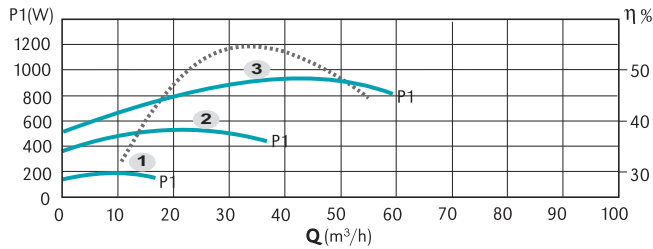
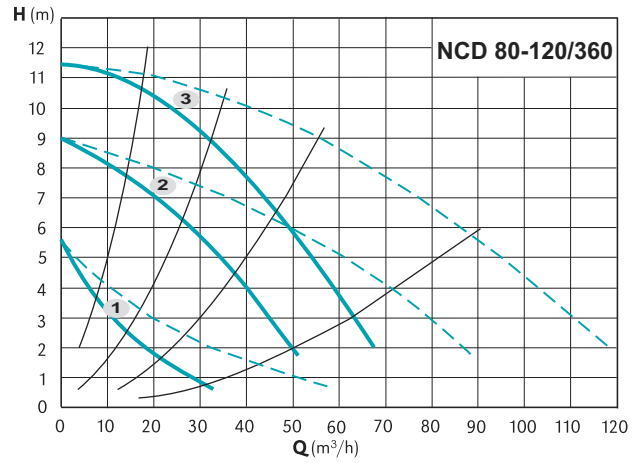
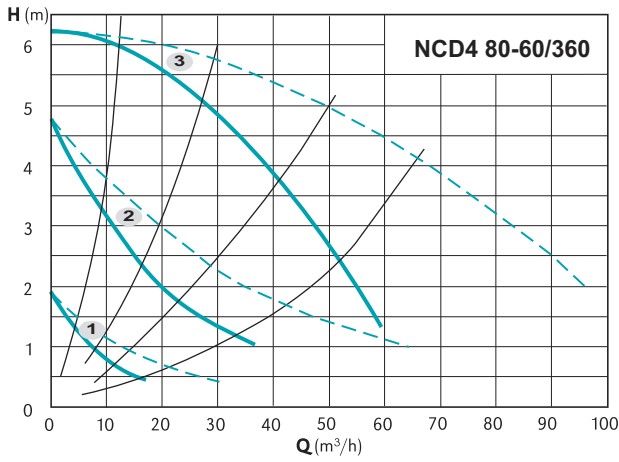

——— Single operation  
- - - - - Operation in parallel

——— Single operation  
- - - - - Operation in parallel

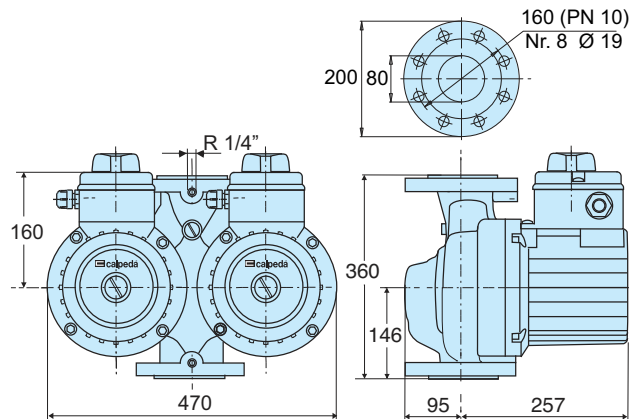

TYPE	DN PN		N° Poli 2 4	Pos.	1/min	P1 (W)	3x 400 V [A]	[kg]
	80	10						
NCD4 80-60/360			✓	3	1350	960	2,20	60,0
				2	1000	560	1,10	
				1	600	200	0,38	
NCD 80-120/360			✓	3	2800	2200	3,80	62,0
				2	2160	1400	2,40	
				1	1200	550	1,05	